

Montageanleitung für Duschwand

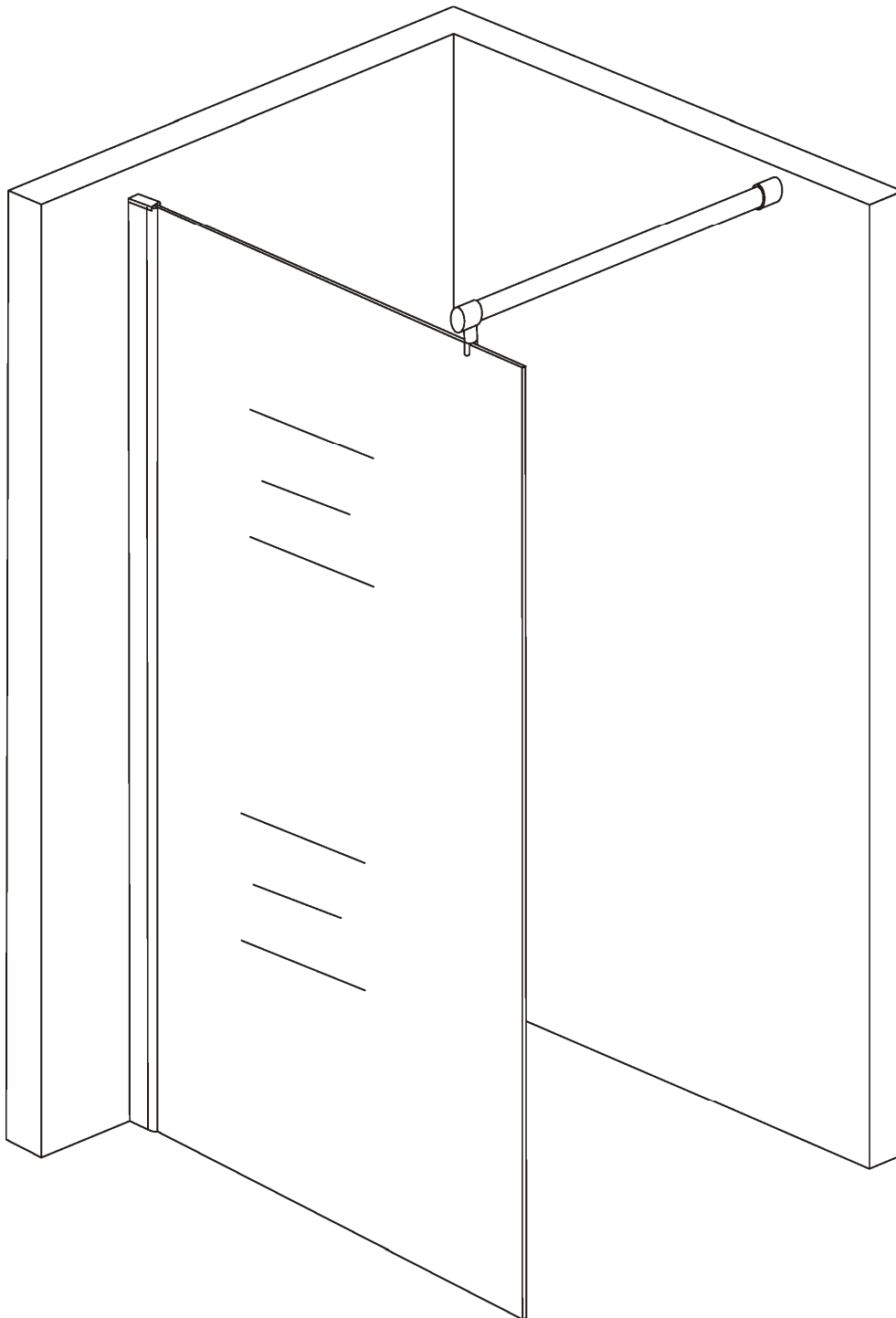

RoHS **CE** **ISO9001:2000**

Benötigtes Werkzeug

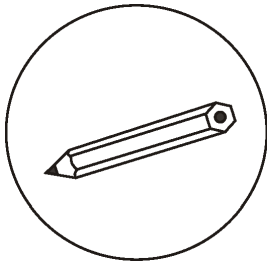

Bleistift

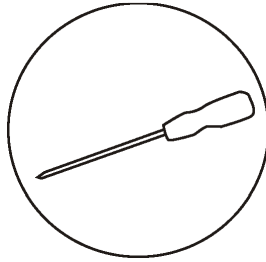

Schraubendreher(Kreuz)

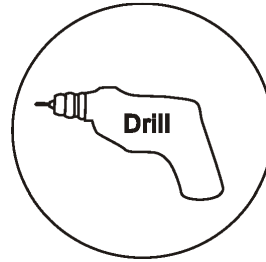

Bohrmaschine

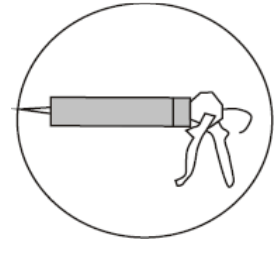

Silikongel

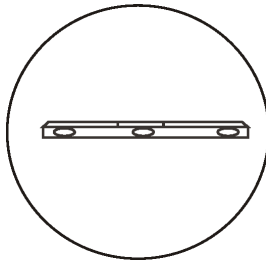

Wasserwaage

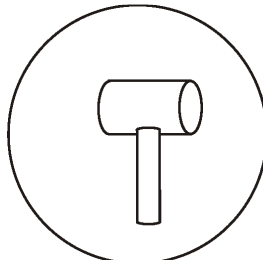

Gummihammer

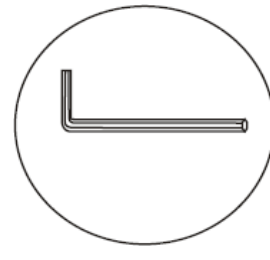

Imbusschlüssel

Teileliste

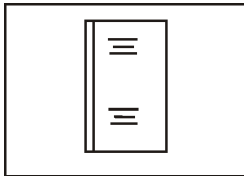

Glaswand

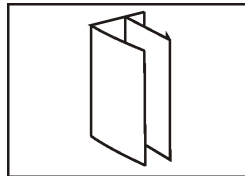

Wand U-Profil

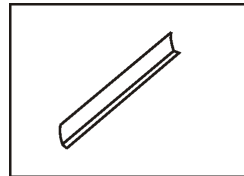

Profil-Abdeckung



P-J4515

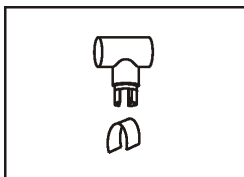

PJ-4416

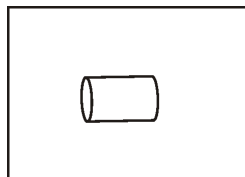

PJ-4405

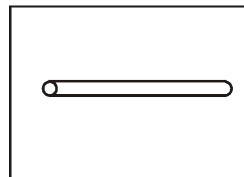

LG-2004

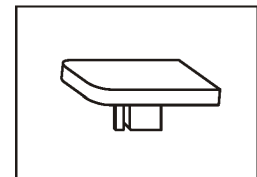

PJ-4506

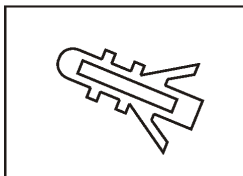

Wand-Dübel

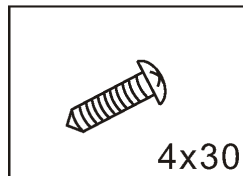

Wand-Schraube

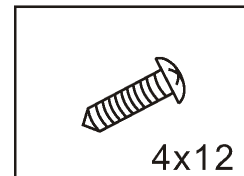

Profil-Schraube

1. Stellen Sie das Wandprofil vertikal auf, nehmen Sie eine Wasserwaage zur Hilfe
2. Markieren Sie die Bohr-Löcher
3. Bohren Sie an der Markierung und setzen Sie die Dübel in die Wand
4. Schrauben Sie das Profil an die Wand

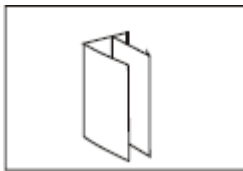

Wandprofil



Wand-Schraube

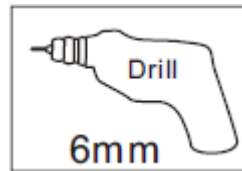

Bohrmaschine



Wand-Dübel

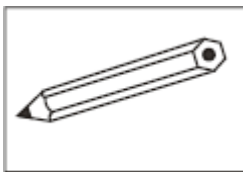

Bleistift

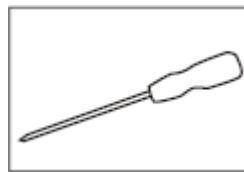

Schraubendreher(Kreuz)

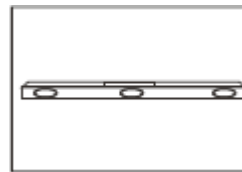

Wasserwaage

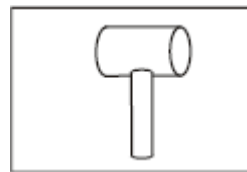

Gummihammer

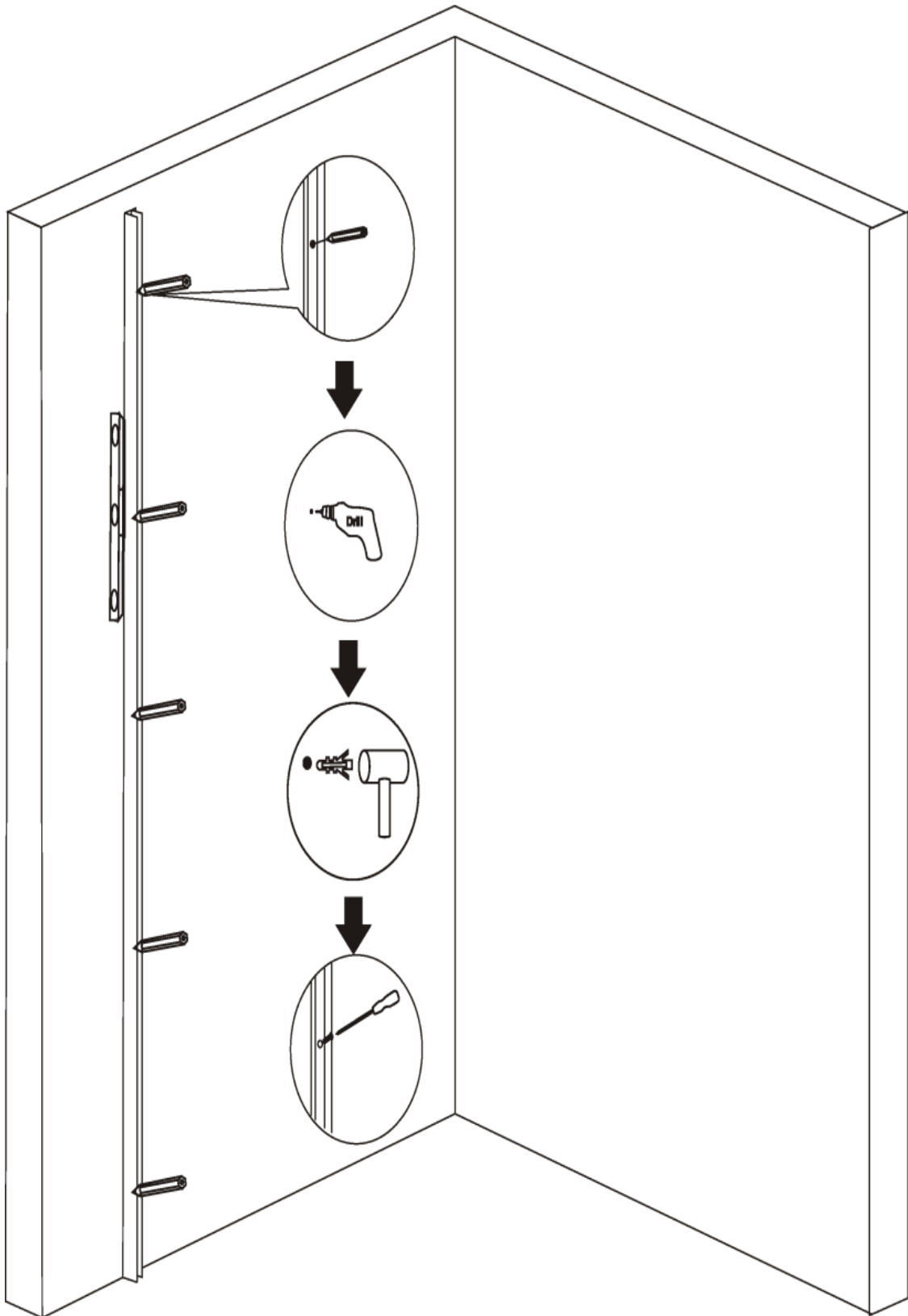

Führen Sie vorsichtig die Duschwand in das Wandprofil (lassen Sie den Kantenschutz am Glas)

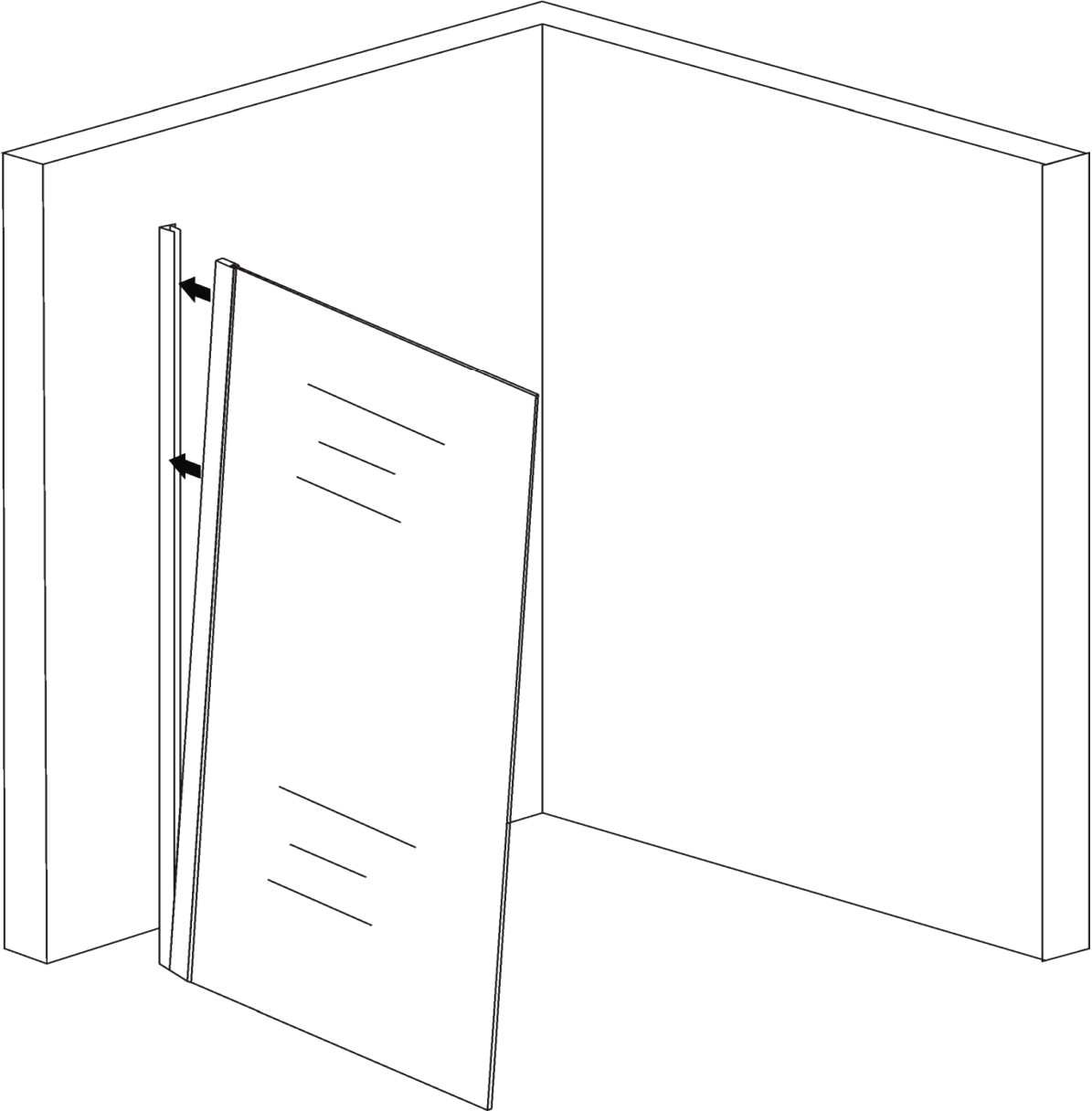
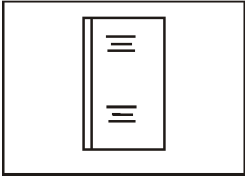

1. Bohren Sie an den vorgesehenen Stellen durch das Wandprofil und fixieren Sie die Duschwand mittels der beigegefügten Schrauben
2. Bringen Sie anschließend die Abdeckleiste zwecks Verdeckung der Verschraubung an, diese ist ein zu klinken

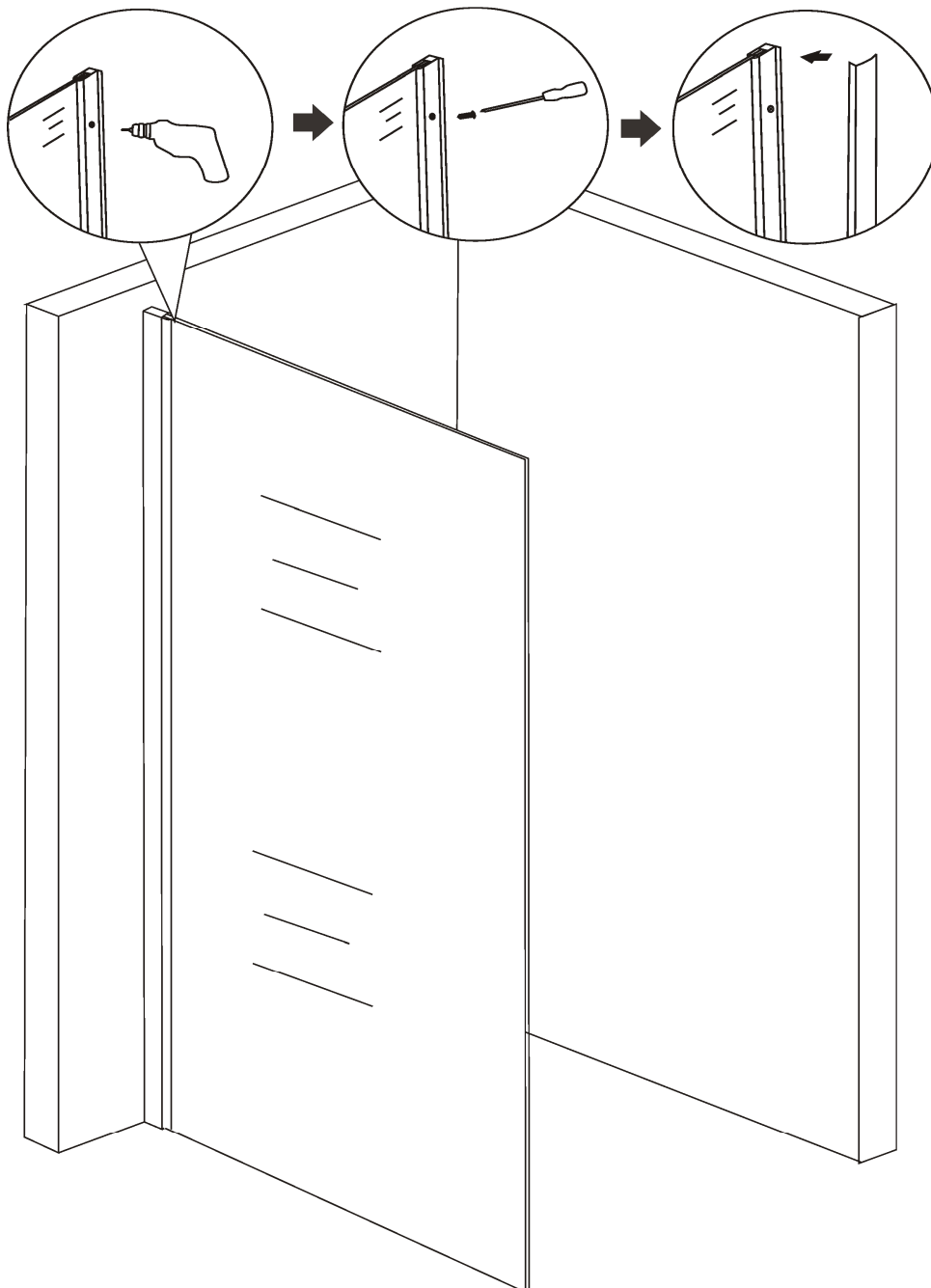
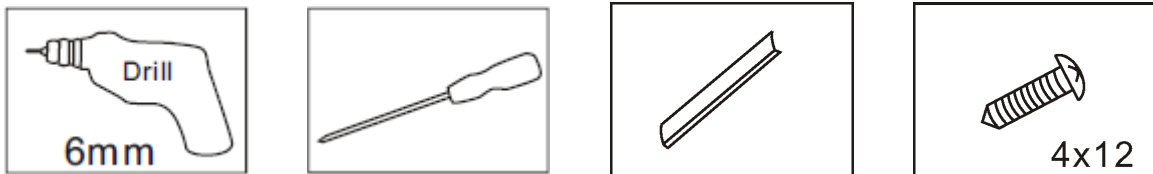

Bringen Sie die obere Profilabdeckung an und versiegeln Sie die Duschwand von innen & außen mittels Silikon

