



CP CPE

90° Post Clamps

BEST



Overview

- For diameter : Ø8 mm (08) / 12 mm (12) / 12.7 mm (13) / 20 mm (20)
- The CP-series supports different diameter posts at an arbitrary mutual angle
- Material: Aluminum (Black anodized)
- Metric / Imperial Version available
- To order Imperial model please add * I- * to Item

Specification & Item Numbers

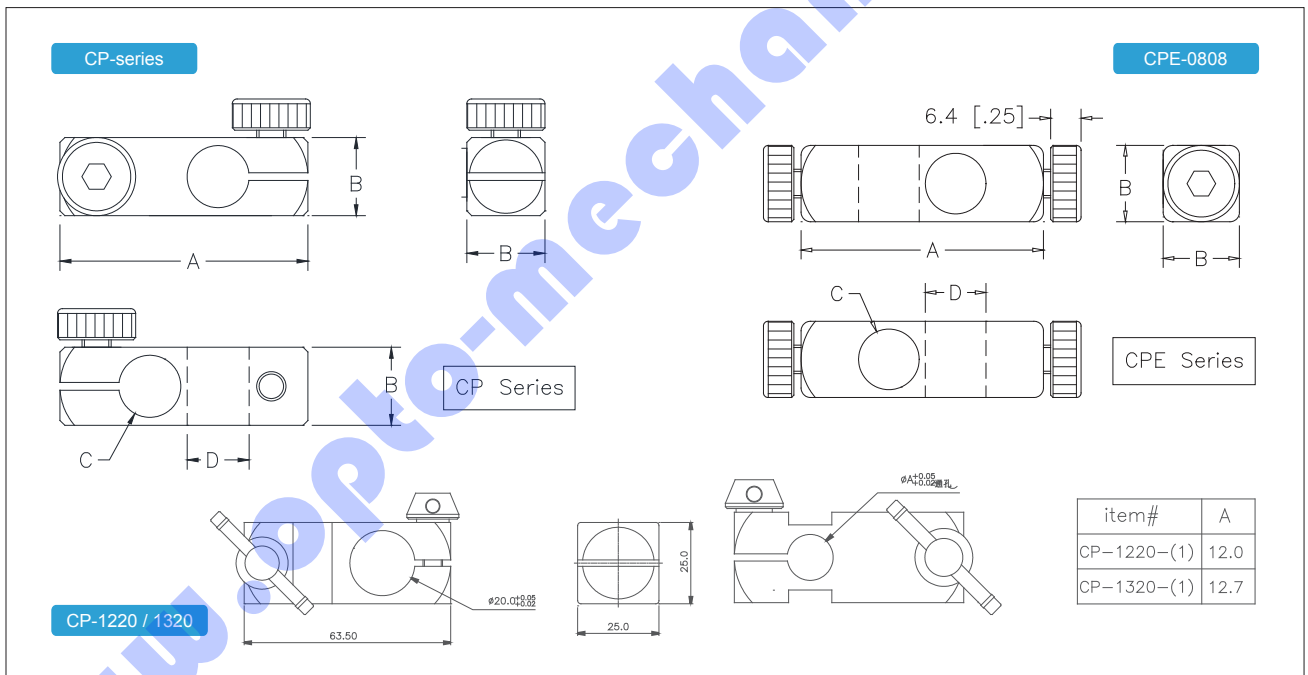

Item Number	Diameter Ø C mm (inch)	Diameter Ø D mm (inch)	Length A mm (inch)	Diameter B mm (inch)
CP-0808 / CPE-0808	8 (0.315")	8 (0.315")	32 (1.26")	12 (0.47")
CP-0812 / CPE-0802	8 (0.315")	12 (0.47")	50 (1.97")	16 (0.63")
CP-0813 / CPE-0813	8 (0.315")	12.7 (0.5")	50 (1.97")	16 (0.63")
CP-1212 / CPE-1212	12 (0.47")	12 (0.47")	50 (1.97")	16 (0.63")
CP-1213 / CPE-1213	12 (0.47")	12.7 (0.5")	50 (1.97")	16 (0.63")
CP-1313 / CPE-1313	12.7 (0.5")	12.7 (0.5")	50 (1.97")	16 (0.63")
CP-1220 / CPE-1220	12 (0.47")	20 (0.785")	63.5 (2.50")	25 (1.97")
CP-1320 / CPE-1320	12.7 (0.5")	20 (0.785")	63.5 (2.50")	25 (1.97")
CP-2020 / CPE-2020	20 (0.785")	20 (0.785")	63.5 (2.50")	25 (1.97")

Universal Post Clamps



Overview

- 4 types of design for your application purpose UCS / UC / UCX / -P-series (with engraved scale)
- UC-series supports two standard diameter 12mm (0.47") and 12.7mm (0.5") of posts
- UCX- series supports two types of post diameter : 12.7mm (0.5") and 20mm (0.785") diameter posts.
- Smooth 360° rotation parallel to each other
- Material: Aluminum (Black anodized)
- Metric / Imperial Version
- To order Imperial model please add * I - * to Item

Specification & Item Numbers

UC / UCS UCX

APPLICATION

Item Number	Diameter Ø C mm (inch)	Diameter Ø D mm (inch)	Length A mm (inch)	Diameter B mm (inch)
UCS-0808	8 (0.315")	8 (0.315")	50 (1.97")	20 (0.79")
UCS-0812	8 (0.315")	12 (0.47")	50 (1.97")	20 (0.79")
UCS-0813	8 (0.315")	12.7 (0.5")	50 (1.97")	20 (0.79")
UCS-1212	12 (0.47")	12 (0.47")	50 (1.97")	20 (0.79")
UCS-1213	12 (0.47")	12.7 (0.5")	50 (1.97")	20 (0.79")
UCS-1313	12.7 (0.5")	12.7 (0.5")	50 (1.97")	20 (0.79")
UC-1212	12 (0.47")	12 (0.47")	60 (2.36")	30 (1.18")
UC-1213	12 (0.47")	12.7 (0.5")	60 (2.36")	30 (1.18")
UC-1313 / P	12.7 (0.5")	12.7 (0.5")	60 (2.36")	30 (1.18")
UCX-1220	12 (0.47")	20 (0.785")	68 (2.68")	36 (1.42")
UCX-1320 / P	12.7 (0.5")	20 (0.785")	68 (2.68")	36 (1.42")
UCX-2020 / P	20 (0.785")	20 (0.785")	76 (3.0")	36 (1.42")

- Optical Tables
- Stages
- Optical Mounts
- Components
- Motion Systems
- Education Systems
- Lasers
- Optics & Crystals
- Other Equipment



CPR

Post Clamps for Arbitrary Mutual Angle

Optical Tables

Stages

Optical Mounts

Components

Motion Systems

Education Systems

Lasers

Optics & Crystals

Other Equipment



CPR-series

Overview

- For diameter : 8 mm (0.315") ~ 08
- For diameter : 12 mm (0.47") ~ 12
- For diameter : 12.7 mm (0.5") ~ 13
- For diameter : 20 mm (0.785") ~ 20

Specification & Item Numbers

CPR-series

APPLICATION

Item Numbers

Item Number	Diameter Ø C mm (inch)	Diameter Ø D mm (inch)	Length A mm (inch)	Diameter B mm (inch)	E mm (inch)	F mm (inch)
CPR-0808	8 (0.315")	8 (0.315")	25 (0.97")	25 (0.97")	12 (0.47")	12 (0.47")
CPR-1212	12 (0.47")	12 (0.47")	25 (0.97")	25 (0.97")	16 (0.63")	16 (0.63")
CPR-1213	12 (0.47")	12.7 (0.5")	25 (0.97")	25 (0.97")	16 (0.63")	16 (0.63")
CPR-1313	12.7 (0.5")	12.7 (0.5")	25 (0.97")	25 (0.97")	16(0.63")	16(0.63")
CPR-1220	12 (0.47")	20 (0.785")	25 (0.97")	38 (1.5")	16 (0.63")	24 (0.95")
CPR-1320	12.7 (0.5")	20 (0.785")	25 (0.97")	38 (1.5")	16 (0.63")	24 (0.95")
CPR-2020	20 (0.785")	20 (0.785")	38 (1.5")	38 (1.5")	24 (0.95")	24 (0.95")

Vertical Brackets



Overview

- The Vertical Bracket is designed to allow our breadboards to be mounted perpendicular to an optical bench
- Material: Aluminum (Black anodized)
- Metric / Imperial Version
- To order Imperial model please add * I - * to Item

Optical Tables

Stages

Optical Mounts

Components

Motion Systems

Education Systems

Lasers

Optics & Crystals

Other Equipment

Specification & Item Numbers

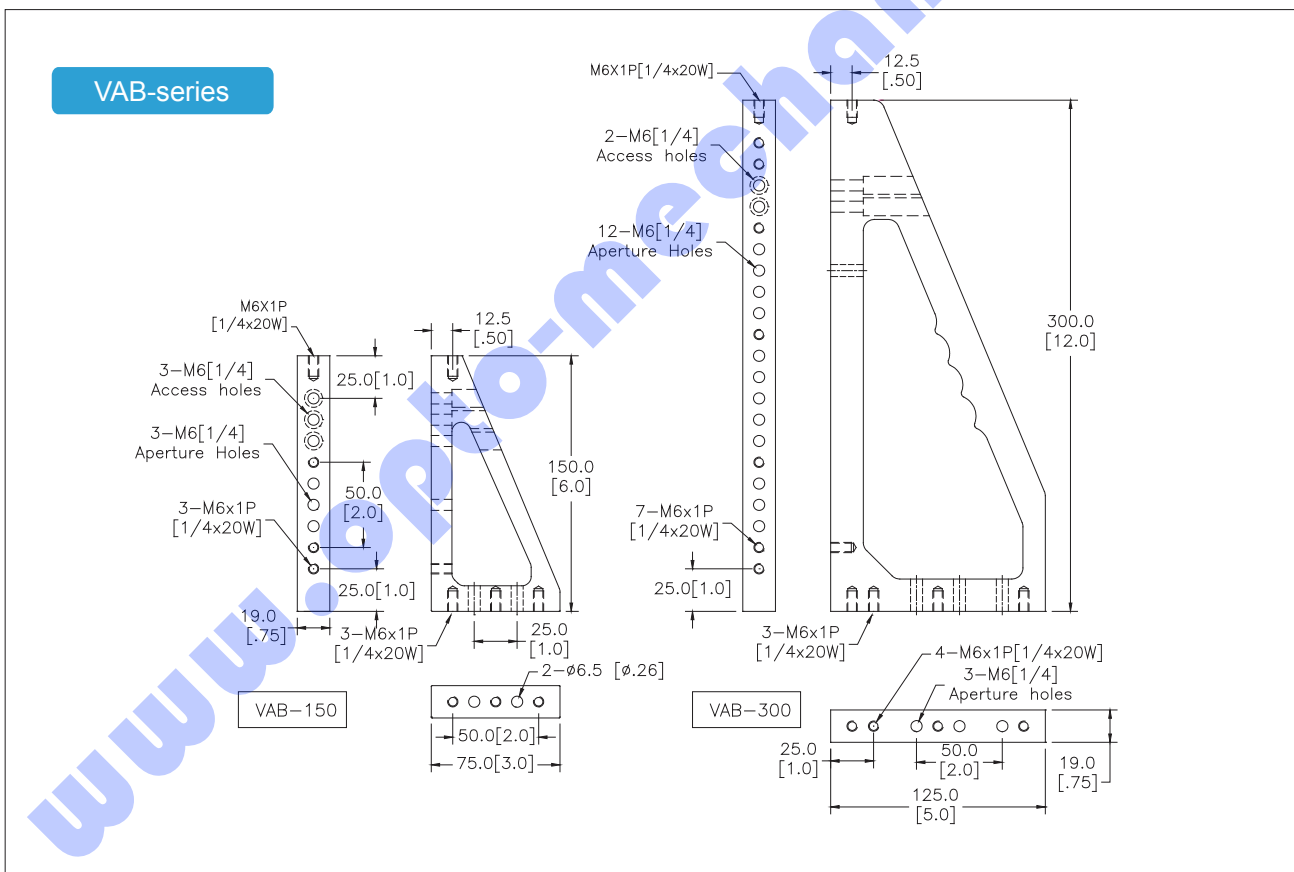

Item Numbers

Item Number	Height mm (inch)	Weight (kg)
VAB-150	150 (6")	0.21
VBA-300	300 (12")	0.68



PB MPB SAB

Solid Aluminum Boards

Optical Tables

Stages

Optical Mounts

Components

Motion Systems

Education Systems

Lasers

Optics & Crystals

Other Equipment



Overview

- Aluminum construction result excellent thermal stability
- *P *:Both surfaces grinded
- Customized specification is acceptable
- Standard screw pattern:
 - SAB : M6x0.7P per 25mm in metric version
#1/4-20w per 1" in imperial version
 - PB : M6x0.7P per 25mm in metric version
#8-32w per 1" in imperial version
 - MPB : M2x0.4P per 10mm in metric version
- To order the handle, please add item number # (HD150-1)
- To order Imperial model please add * I- * to Item

Specification & Item Numbers

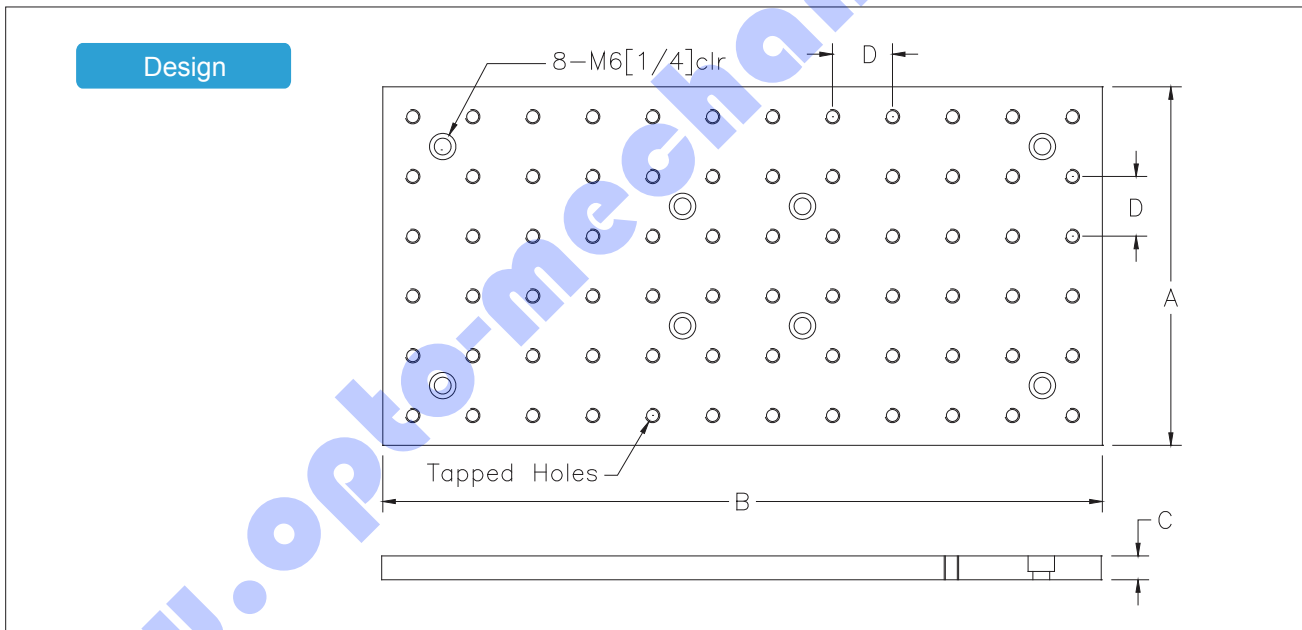

Item Numbers

Item Number	Size: AxB mm (inch)	Thickness: C mm (inch)	Tapped Holes Platter mm (inch)	Flatness (mm)	Tapped Holes	Weight (kg)
PB-1212	120 (5") x 120 (5")	10 (0.4")	25 (1.0") apart	±0.05	M4x0.7P or #8x32W	0.32
PB-1212P	120 (5") x 120 (5")	9.8 (0.38")	25 (1.0") apart	±0.015	M4x0.7P or #8x32W	0.32
PB-1220	120 (5") x 200 (8")	10 (0.4")	25 (1.0") apart	±0.05	M4x0.7P or #8x32W	0.56
PB-1220P	120 (5") x 200 (8")	9.8 (0.38")	25 (1.0") apart	±0.015	M4x0.7P or #8x32W	0.56
PB-2030	200 (8") x 300 (12")	10 (0.4")	25 (1.0") apart	±0.05	M4x0.7P or #8x32W	1.30
PB-2030P	200 (8") x 300 (12")	9.8 (0.38")	25 (1.0") apart	±0.015	M4x0.7P or #8x32W	1.30
PB-3030	300 (12") x 300 (12")	10 (0.4")	25 (1.0") apart	±0.05	M4x0.7P or #8x32W	2.33
PB-3030P	300 (12") x 300 (12")	9.8 (0.38")	25 (1.0") apart	±0.02	M4x0.7P or #8x32W	2.33



Item Number	Size: AxB mm (inch)	Thickness: C mm (inch)	Tapped Holes Platter mm (inch)	Flatness (mm)	Tapped Holes	Weight (kg)
MPB-1216	120x160	8 (0.3")	10 apart	±0.03	M2x0.4P	0.41
MPB-1216P	120x160	7.8 (0.3")	10 apart	±0.01	M2x0.4P	0.41
MPB-1220	120x200	8 (0.3")	10 apart	±0.03	M2x0.4P	0.76
MPB-1220P	120x200	7.8 (0.3")	10 apart	±0.01	M2x0.4P	0.76
MPB-2030	200x300	8 (0.3")	10 apart	±0.03	M2x0.4P	1.28
MPB-2030P	200x300	8 (0.3")	10 apart	±0.01	M2x0.4P	1.28

Item Number	Size: AxB mm (inch)	Thickness: C mm (inch)	Tapped Holes Platter mm (inch)	Flatness (mm)	Tapped Holes	Weight (kg)
SAB-1530	150 (6") x 300 (12")	10.0 (0.4")	25 (1.0") apart	±0.03	M6x1.0P or 1/4"x20W	1.47
SAB-1530P	150 (6") x 300 (12")	9.7 (0.4")	25 (1.0") apart	±0.01	M6x1.0P or 1/4"x20W	1.47
SAB-3030	300 (12") x 300 (12")	13 (0.5")	25 (1.0") apart	±0.04	M6x1.0P or 1/4"x20W	2.95
SAB-3030P	300 (12") x 300 (12")	12.7 (0.5")	25 (1.0") apart	±0.01	M6x1.0P or 1/4"x20W	2.95
SAB-3045	300 (12") x 450 (18")	13 (0.5")	25 (1.0") apart	±0.04	M6x1.0P or 1/4"x20W	4.55
SAB-3045P	300 (12") x 450 (18")	12.7 (0.5")	25 (1.0") apart	±0.01	M6x1.0P or 1/4"x20W	4.55
SAB-3060	300 (12") x 600 (24")	13 (0.5")	25 (1.0") apart	±0.05	M6x1.0P or 1/4"x20W	6.10
SAB-3060P	300 (12") x 600 (24")	12.7 (0.5")	25 (1.0") apart	±0.015	M6x1.0P or 1/4"x20W	6.10
SAB-4560	450 (18") x 600 (24")	12.7 (0.5")	25 (1.0") apart	±0.05	M6x1.0P or 1/4"x20W	9.04
SAB-4575	450 (18") x 750 (30")	12.7 (0.5")	25 (1.0") apart	±0.05	M6x1.0P or 1/4"x20W	8.96
SAB-6075	600 (24") x 750 (30")	12.7 (0.5")	25 (1.0") apart	±0.05	M6x1.0P or 1/4"x20W	10.63
SAB-6090	600 (24") x 900 (35")	12.7 (0.5")	25 (1.0") apart	±0.05	M6x1.0P or 1/4"x20W	12.11
SAB-7590	750 (30") x 900 (35")	12.7 (0.5")	25 (1.0") apart	±0.05	M6x1.0P or 1/4"x20W	13.46
SAB-75120	750 (30") x 1200 (47")	12.7 (0.5")	25 (1.0") apart	±0.05	M6x1.0P 1/4"x20W	19.36

Optical Tables

Stages

Optical Mounts

Components

Motion Systems

Education Systems

Lasers

Optics & Crystals

Other Equipment



MB

Magnetic Bases

Optical Tables

Stages

Optical Mounts

Components

Motion Systems

Education Systems

Lasers

Optics & Crystals

Other Equipment

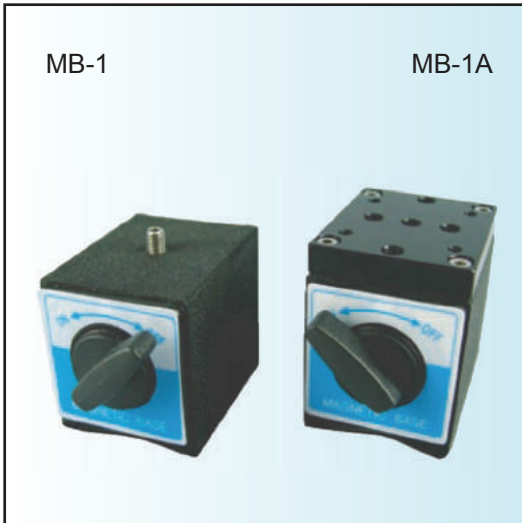

Overview

- 2 Models for selection MB-1 / MB-1A
- MB-1 with screw on top surface
- Magnetic bottom and back surface
- MB-1A with Imperial or Metric tapped mounting holes on top surface

Specification & Item Numbers

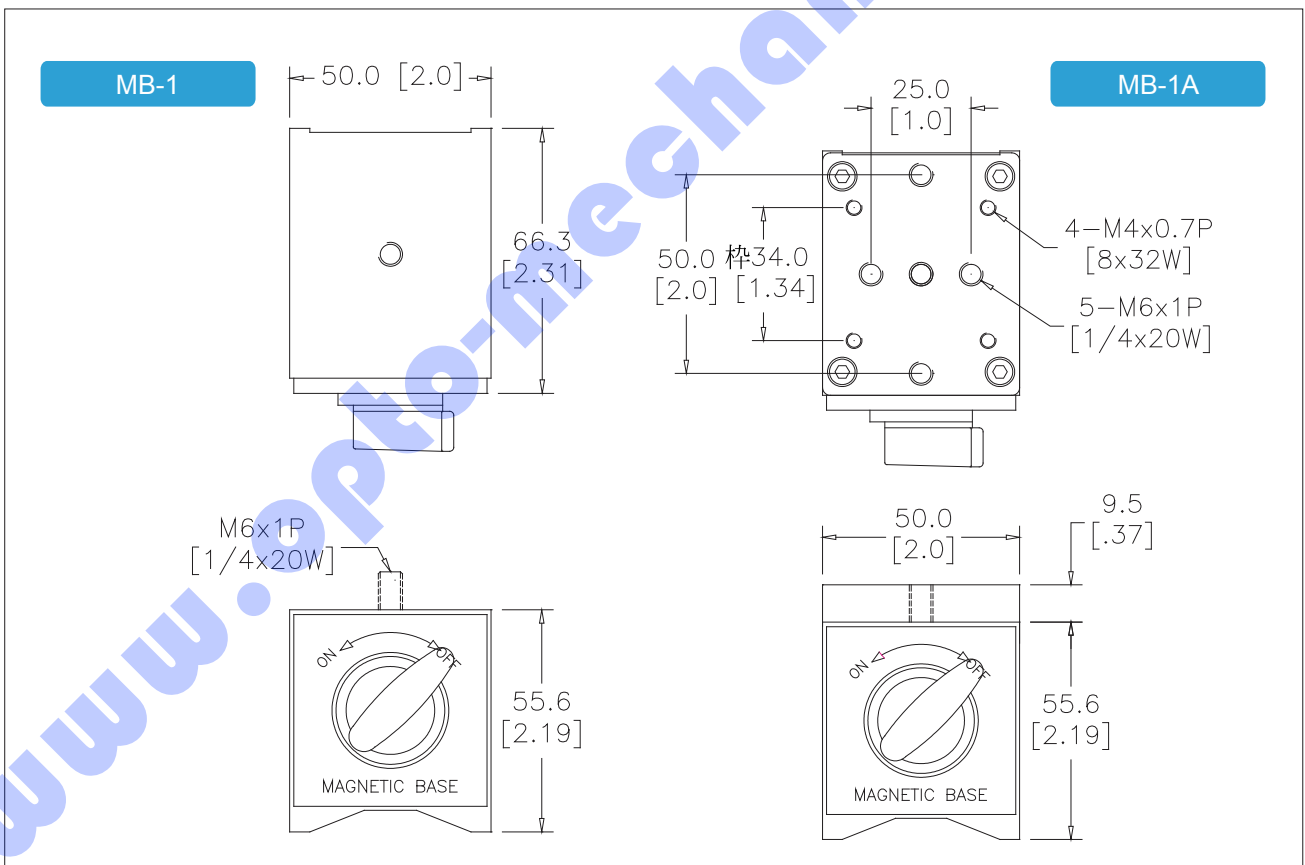

Item Numbers

Item Number	Upper Surface mm (inch)	Holding Force	Weight (kg)
MB-1A	50X64 (1.97x2.52")	60.0	1.65
MB-1	50X64 (1.97x2.52")	60.0	1.07

Thin Magnetic Bases

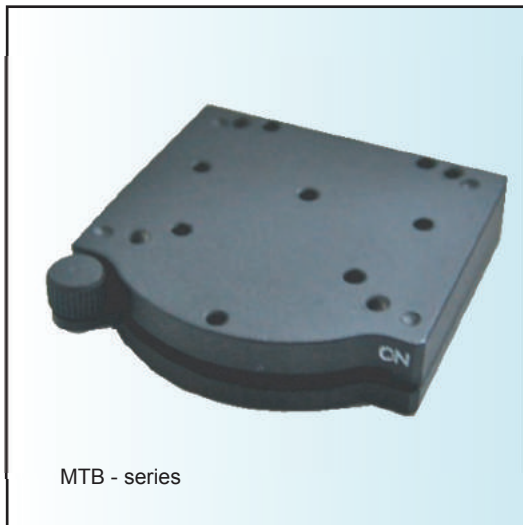

MTB - series

Overview

- Slim and light weighted design
- Stable and fast magnetic attraction
- Custom made fixing holes to meet customers' needs
- Anti-Oxidized surface treatment

Specification & Item Numbers

Steps of operation

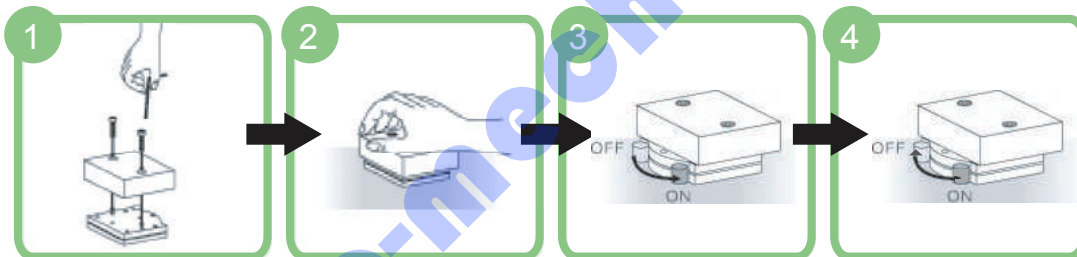

1 First, assemble the magnetic base with other small components

2 Then place the magnetic base onto an iron surface

3 Secure the base position by turning on the magnetic attraction

4 Reverse all steps from before when taking off the magnetic bases

MTB-series

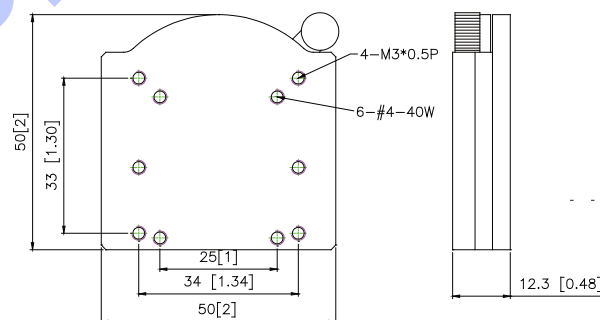

Item Number	Magnetic Attraction	Dimension (WxDxH) mm	Load Capacity (kg)
MTB-032	80N (8.16kgf)	32x32x12	<3.2
MTB-038	100N (10.2kgf)	38x38x12	<3.2
MTB-052	147N (15kgf)	50x50x12	<6
MTB-066	152N (8.16kgf)	50x50x12	<6



BD BDC

Water-Cooling Beam Dumper

Optical Tables

Stages

Optical Mounts

Components

Motion Systems

Education Systems

Lasers

Optics & Crystals

Other Equipment

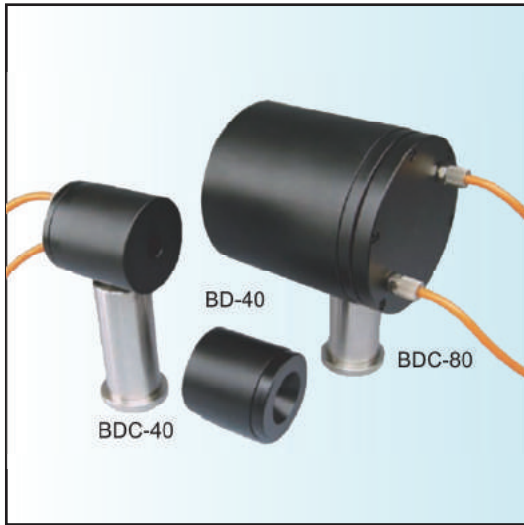

Overview

- The photo-receiver is suitable for the strict scientific requirement and precision engineering applications
- BDC-series features water cooling to avoid high temperature
- Complete system including M5 connecting screw for pipe (pipe not included). Bottom with M6 tapped screw for mounting

Specification & Item Numbers

BDC-series

Item #	A	B	C	D	E
BDC-40	ø42 [1.65]	ø20 [.79]	ø12 [.47]	ø20 [.79]	ø40 [1.58]
BDC-80	ø81 [3.19]	ø40 [1.58]	ø52 [2.05]	ø60 [2.36]	ø88 [3.46]

BD-series

Item #	A	B	C	D	E
BD-40	ø40 [1.58]	ø20 [.79]	ø12 [.47]	ø20 [.79]	ø40 [1.58]
BD-80	ø80 [3.15]	ø40 [1.58]	ø52 [2.05]	ø60 [2.36]	ø88 [3.46]

Item Numbers

Item Number	Weight (kg)
BD-40	0.10
BDC-40	0.12
BD-80	0.55
BDC-80	0.7

Precision Spatial Filter



Overview

- X-Y pinhole adjustment
- Base unit provides 2-axis tilting adjustment, 0.3 mrad resolution
- 100-ptich Screw driven
- Additional PHR, the modular pinhole holder for easy pinhole replacement
- Objective holder with back and forth fine adjustment: 1 μ m.
- Applied to 4X to 60X objectives

Specification & Item Numbers

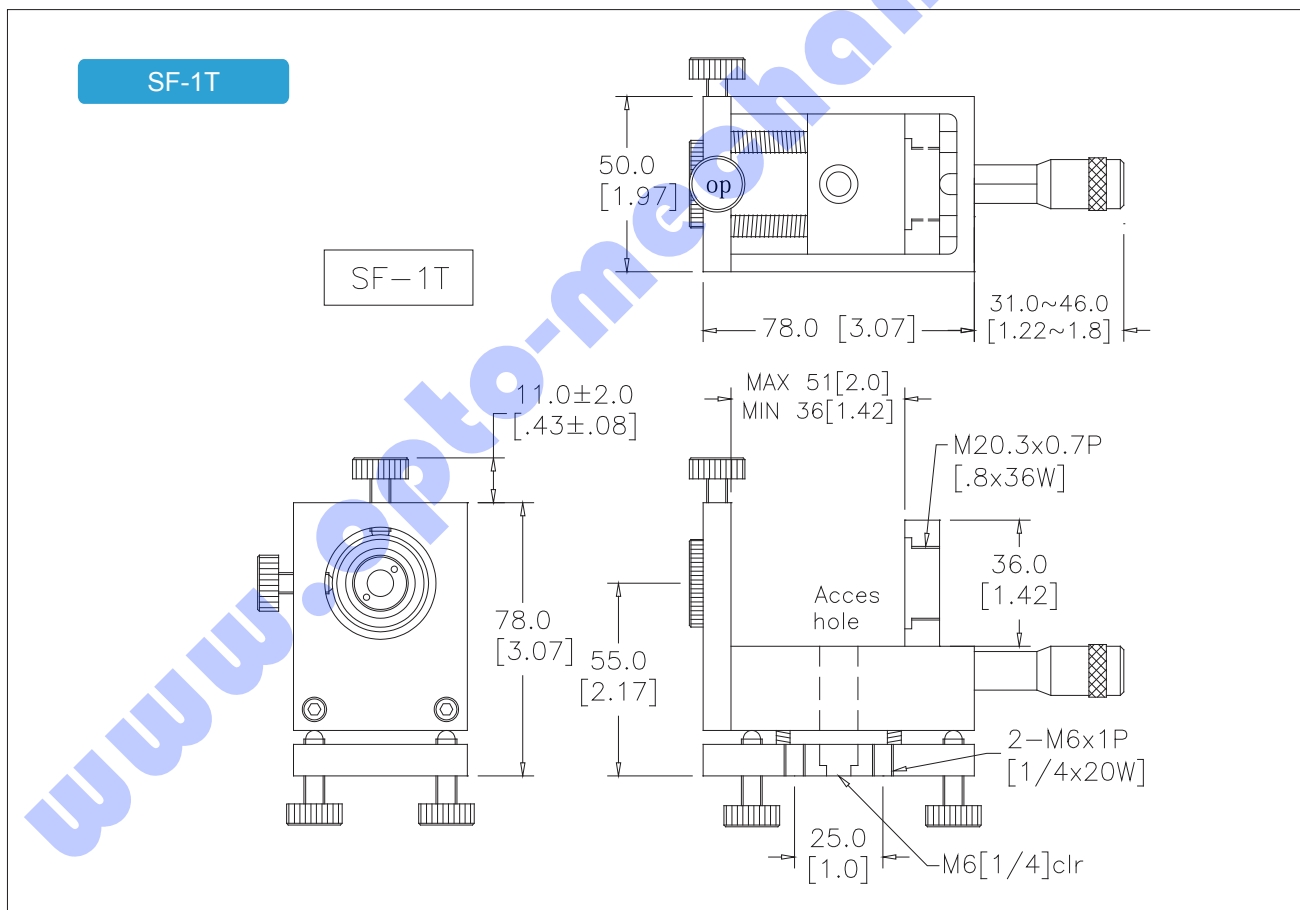

Item Numbers

Item Number	Driver Type	Height mm (inch)	Pinhole Carrier Resoluton (mm)	Base Unit Resolution (mrad)	Weight (kg)
SF-1T	100	55 (2.16")	0.001	0.3	0.44



FSA FSB FSC FSD

M4 & M6 100-pitch Adjustment Screws

Optical Tables

Stages

Optical Mounts

Components

Motion Systems

Education Systems

Lasers

Optics & Crystals

Other Equipment

Overview

M6 100-pitch Adjustment Screws

- 4 types of screw knob to fit different applications
- 100tpi fine screw with brass sleeve standard O.D. M10x0.5p
- Screw Length: 16 mm (0.63") ~ 68 mm (2.68")

M4 100-pitch Adjustment Screws

- 3 types of screw knob to fit different applications
- 100tpi fine screw with brass sleeve standard O.D. is 6 mm diameter
- Screw Length: 13 mm (0.51") ~ 23 mm (0.91")



Specification & Item Numbers

FSA6-series

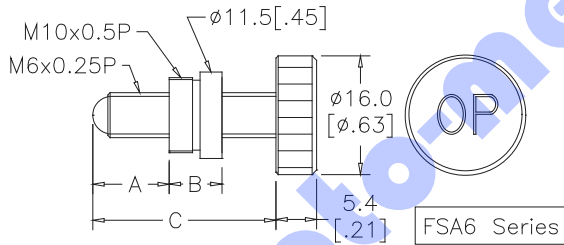

FSB6-series

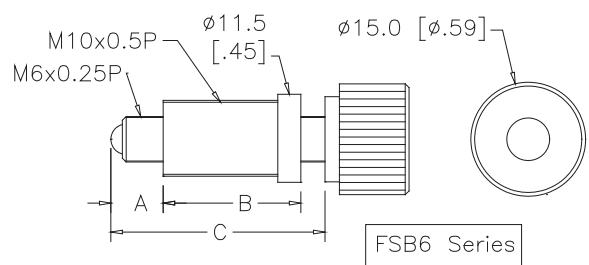

FSC6-series

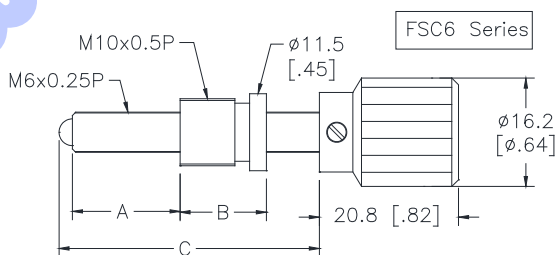

FSD6-series

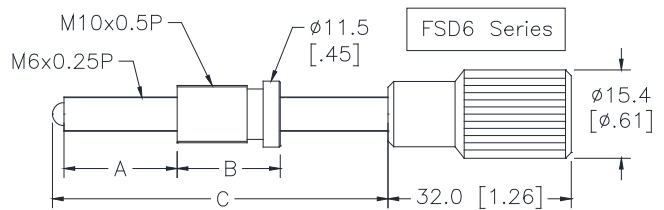

FSA4-series

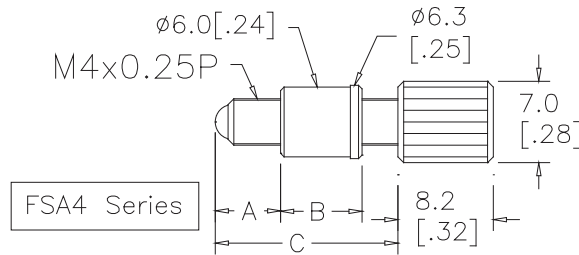

FSB4-series

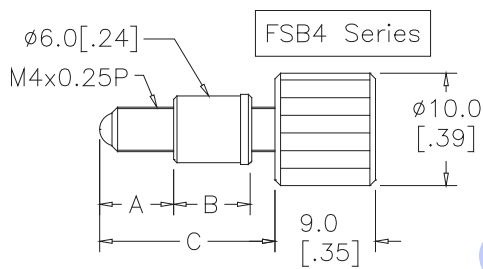

FSC4-series

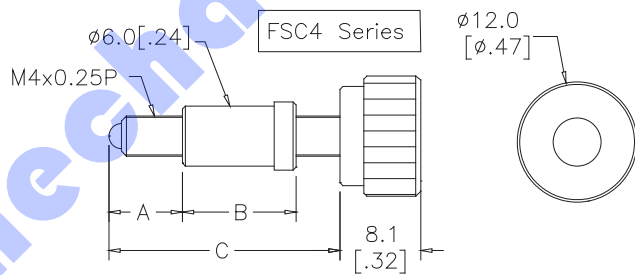

Item Numbers

Item Number	A MAX mm (inch)	B mm (inch)	C mm (inch)
FSA6-9	9 (0.35")	7 (0.28")	16 (0.63")
FSA-16	16 (0.63")	7 (0.28")	23 (0.91")
FSA6-20	20 (0.78")	13 (0.51")	34 (1.33")
FSB-9	9 (0.35")	18 (0.72")	28 (1.26")
FSB-12	12 (0.47")	18 (0.72")	32 (1.26")
FSC-25	25 (1.0")	13 (0.51")	38 (1.5")
FSC6-30	30 (1.18")	13 (0.51")	44 (1.73")
FSD6-40	40 (1.57")	18 (0.72")	58 (2.28")
FSD6-50	50 (1.97")	18 (0.72")	68 (2.68")
FSA4-6	6 (0.23")	7 (0.28")	13 (0.51")
FSB4-10	10 (0.28")	7 (0.28")	17 (0.67")
FSC4-7	7 (0.31")	11 (0.43")	18 (0.72")
FSC4-12	12 (0.47")	11 (0.43")	23 (0.91")



TAI TAE

Screw Adapters

BEST



TAI-series

TAE-series

Overview

- TAE-series: External Threaded adapter
- TAI-series: Internal Threaded adapter
- Suitable for various optical mechanical parts switching

Specification & Item Numbers

TAE-1~4

TAE1~4

TAE-5

TAE-5

TAI-1~5

TAI-1~5

TAI-6

TAI-6

型號	A	B
TAE-1	8-32W	1/4-20W
TAE-2	8-32W	M6
TAE-3	M4	M6
TAE-4	M4	1/4-20W
TAE-5	M6	1/4-20W

item#	A	B
TAI-1	#8-32	1/4-20
TAI-2	#8-32	M6
TAI-3	M4	M6
TAI-4	M4	1/4-20
TAI-5	M6	1/4-20
TAI-6	M6	M16

Item Number	Screw Size A	Screw Size B
TAI-1	#8X32W	1/4x20W
TAI-2	#8X32W	M6x1P
TAI-3	M4x0.7P	M6x1P
TAI-4	M4x0.7P	1/4x20W
TAI-5	M6x1P	1/4x20W
TAI-6	M6x1P	M16x1P
TAE-1	#8x32W	1/4x20W
TAE-2	#8x32W	M6x1P
TAE-3	M4x0.7P	M6x1P
TAE-4	M4x0.7P	1/4x20W
TAE-5	M6x1P	1/4x20W

Clamp Screws

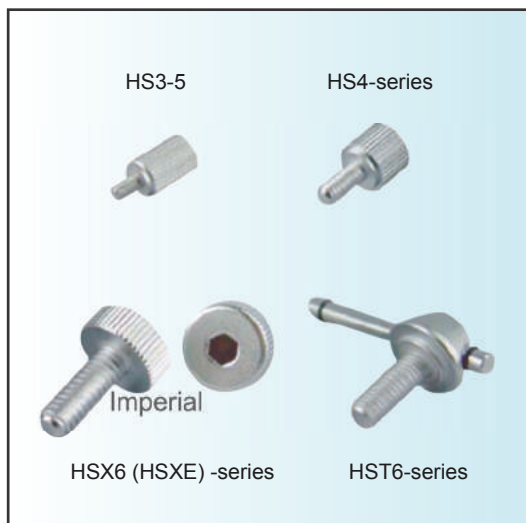

Overview

- HSX-series - Metric / Imperial thread Version
- HSXE-series - Metric / Imperial thread Version
- Both series with M6 hexagon Head for common usage.

Specification & Item Numbers

HS3-5

HS4-6 / 9 / 12

Item#	L
HST6-16	16.0 [6.30]
HST6-25	25.0 [1.0]

HST6-16 / 25

Item#	L
HS4-6	6.0 [.24]
HS4-9	9.0 [.35]
HS4-12	12.0 [.50]

Item#	L	THD A
HSX6-12	12.0 [.50]	M6x1P
HSX6-16	16.0 [.63]	M6x1P
HSXE6-12	12.0 [.50]	1/4x20W
HSXE6-16	16.0 [.630]	1/4x20W
HSXE6-18	18.0 [.71]	1/4x20W

HSX6 & HSXE-series

Item Number	Applicable pitch	Length mm (inch)
HS3-5	M3x0.5P	5 (0.2")
HS4-6	M4x0.7P	6 (0.23")
HS4-9	M7x0.7P	9 (0.35")
HS4-12	M7x0.7P	12 (0.47")
HSX6-12	M6x1P	12 (0.47")
HSX6-16	M6x1P	16 (0.63")
HSXE-12	1/4x20W	12 (0.47")
HSXE-16	1/4x20W	16 (0.63")
HSXE-18	1/4x20W	18 (0.7")
HST6-16	M6x1P	16 (0.63")
HST6-25	M6x1P	25 (0.97")



SK SKS

Screw Kits

Optical Tables

Stages

Optical Mounts

Components

Motion Systems

Education Systems

Lasers

Optics & Crystals

Other Equipment



Overview

- SK-series is Aluminum material
- SKS-series is stainless material
- Kits includes different sizes screw, washer, hex wrench and etc
- Metric / Imperial Version
- To order Imperial model please add * I- * to Item

Item Numbers

I-SKS-1/ I-SK-1 (Imperial Thread)		
Type	Specification (Length =Inch)	Quantity
Socket Head Set Screw	#8 x 32 (3/8")	20
	#8 x 32 (1/2")	20
	1/4 x 20 (1/2")	20
	1/4 x 20 (5/8")	20
Socket Head Cap Screw	1/4 x 20 (3/8")	20
	1/4 x 20 (1/2")	20
	1/4 x 20 (5/8")	20
	1/4 x 20 (3/4")	20
	1/4 x 20 (1.0")	10
	#8 x 32 (3/8")	20
	#8 x 32 (1/2")	20
	#8 x 32 (5/8")	20
Washers	# 8	20
	1/4"	20
Hex Wrenches	1/16 · 5/64 · 3/16 · 1/8 5/32 · 3/16	1 set

SKS-1/SK-1 (Metric Thread)		
Type	Specification (Length =mm)	Quantity
Set Screw	M4 x 0.7 (8.0)	20
	M4 x 0.7 (12.0)	20
	M6 x 1 (12.0)	20
	M6 x 1 (16.0)	20
	M6 x 1 (8.0)	20
Cap Screw	M6 x 1 (12.0)	20
	M6 x 1 (16.0)	20
	M6x1 (20.0)	20
	M6 x 1 (25.0)	20
	M4 x 0.7 (10.0)	20
	M4 x 0.7 (12.0)	20
	M4 x 0.7 (16.0)	20
Washers	O.D.10.4mm	20
	O.D.13.2mm	20
Hex Wrenches	1.5 · 2.0 · 2.5 · 3.0 4.0 · 5.0	1 set

Washer

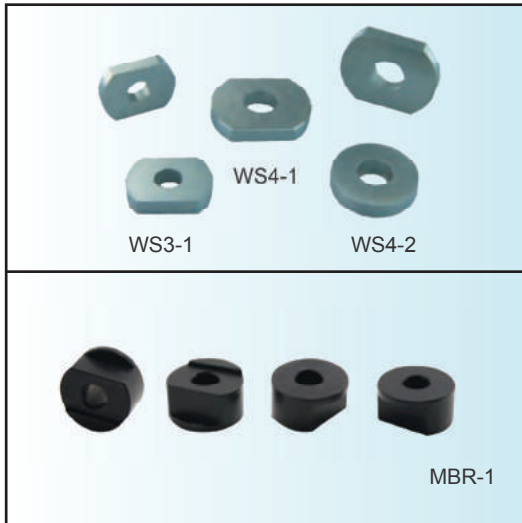

Overview

WS3 / WS4

- WS-series: adapted washer for holding fork
- Metric / Imperial Version
- To order Imperial model please add * I- * to Item

MPR-1

- A set of four to secure PRS-80A / PRS-80D (with baseplate removed) directly to translation stages

Specification & Item Numbers

WS 3 / 4-series

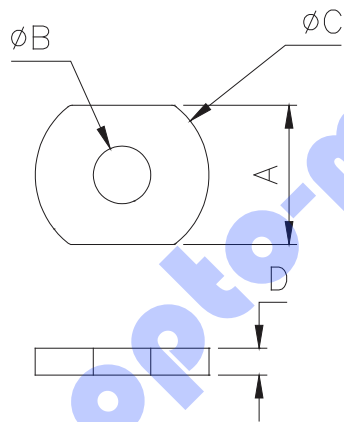

Item#	WS4-1 Series	WS3-1 Series	WS4-2 Series
A	10.4[.41]	7.2[.28]	10.4[.41]
B	4.3[.17]	3.2[.13]	4.3[.17]
C	13[.51]	10[.39]	10.4[.41]
D	2[.07]		

MBR-1

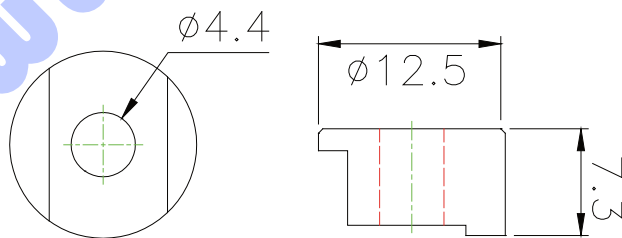

APPLICATION



Can be used in combination



ME

Micrometer Head

Optical Tables

Stages

Optical Mounts

Components

Motion Systems

Education Systems

Lasers

Optics & Crystals

Other Equipment



Overview

- ME-series are readable line: 0.01mm
- ME-25D digital display micrometer, High Resolution: 0.001mm
- The ME-25D high resolution digital micrometer offers easy reading, gearless precision with both Imperial and Metric measurements

Specification & Item Numbers



MER-06



MER-08



ME-13

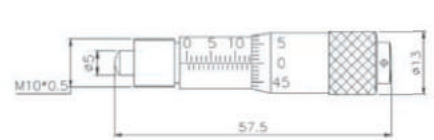
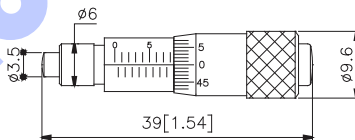
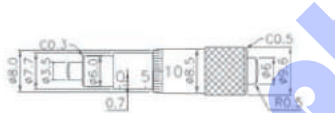

MER-13



MER-15



ME-25

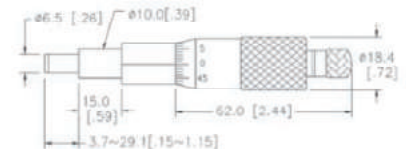
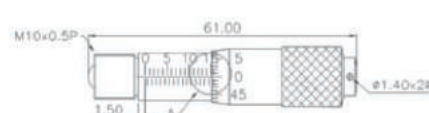
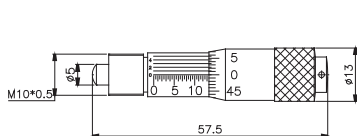



MER-25



MER-25V



MER-50

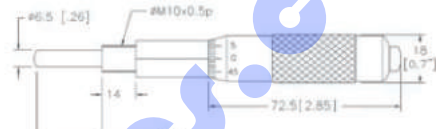
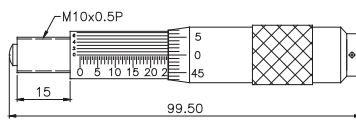
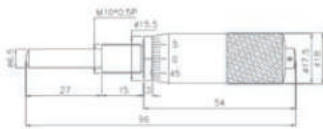

MER-13P

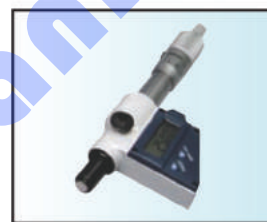

ME-25D

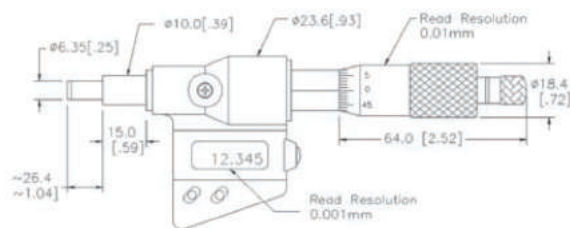
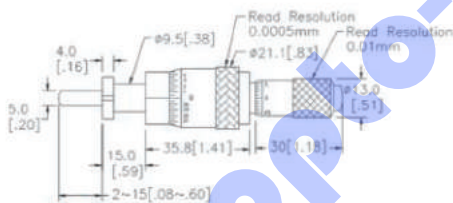

Item Number	Travel mm (inch)	Travel Min mm (inch)	Travel Max mm	Resolution (mm)
MER-06	3.0 (0.11")	2 (0.08")	7.0 (0.27")	0.01
MER-08	6.0 (0.23")	2 (0.08")	9.0 (0.35")	0.01
ME-13	13.0 (0.51")	3 (0.12")	14 (0.55")	0.01
MER-13	13.0 (0.51")	3 (0.12")	14 (0.55")	0.01
MER-15	15.0 (0.59")	3 (0.12")	16 (0.62")	0.01
ME-25	25.0 (1.0")	3.7 (0.15")	26 (1.02")	0.01
MER-25	25.0 (1.0")	3.7 (0.15")	26 (1.02")	0.01
MER-50	50.0 (2.0")	5.7 (0.22")	51 (2.0")	0.01
MER-13P	13.0 (0.51")	2.0 (0.08")	14 (0.55")	0.0005
MER-25V	25.0 (1.0")	3.7 (0.15")	26 (1.02")	0.01
MER-25D	25.0 (1.0")	1.0 (0.04")	26 (2.0")	0.001



Pinhole & Air Slit Apertures

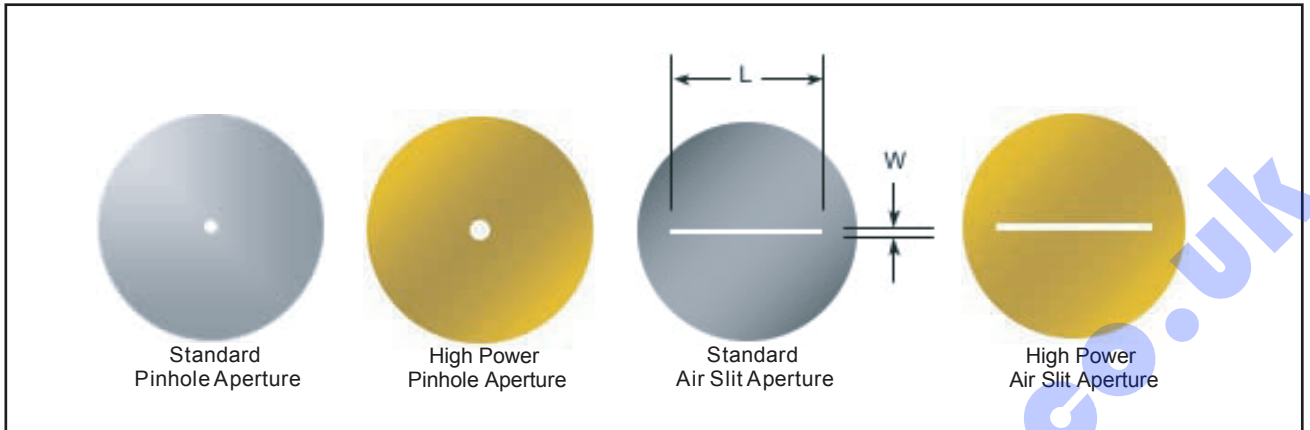

Standard Pinhole Aperture

- Finish: Unblackened.
- Material: 302 stainless steel, non-magnetic (except for HS option)
- Diameter: 9.53mm, (0.375 inch).
- Tolerance: \varnothing 0.15mm, (0.006 inch).
- Thickness: 12.7 μ m (0.0005 inch) on holes 5 μ m and up.

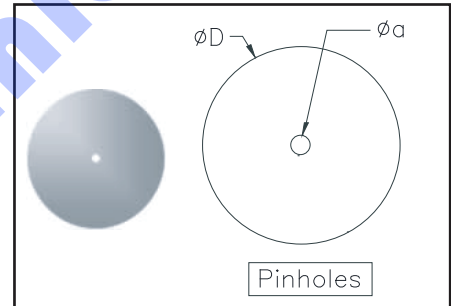

Standard Precision Round Apertures										
Part No.	1-2.0	1-3.0	1-5.0	1-7.5	1-10	1-15	1-20	1-25	1-30	1-35
Size ($\varnothing a$) (um)	2.0	3.0	5.0	7.5	10	15	20	25	30	35
Tolerance (um)	± 0.5	± 0.5	± 1	± 1	± 1	± 1.5	± 2	± 2	± 2	± 2
Part No.	1-40	1-50	1-75	1-100	1-150	1-200	1-300	1-400	1-500	1-600
Size ($\varnothing a$) (um)	40	50	75	100	150	200	300	400	500	600
Tolerance (um)	± 3	± 3	± 3	± 4	± 6	± 6	± 8	± 10	± 10	± 10
Material	Stainless Steel									

High Power Pinhole Aperture

- Material: Copper
- Finish: Gold plated one side, flat poly black (98% emissivity) on reverse side
- Diameter: 9.525mm, (0.375 in., maximum)
- Positional Tolerance: \varnothing 0.1524mm (\varnothing 0.006 inch)
- Thickness: 25 μ m (0.001 in.)

High Power Precision Round Apertures "Pinhole"					
Part No.	3-5	3-10	3-15	3-25	3-50
Size(a) (Microns) (um)	5.0	10	15	25	50
Tolerance (um)	± 1	± 1	± 1.5	± 2	± 3
Material	Copper				

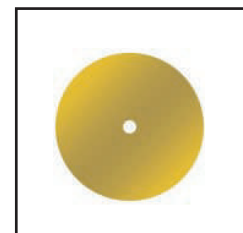



Standard Air Slit Aperture

- Finish: Unblackened.
- Edge Finish : <40 -inch nominal
- Material: 302 stainless steel, non-magnetic (except for HS option)
- Diameter: 9.53mm, (0.375 inch).
- Tolerance: ± 0.15 mm, (0.006 inch).
- Thickness: 12.7 μ m (0.0005 inch) on

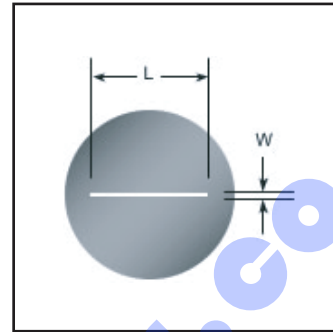

Standard Precision Air Slit								
PRODUCT NUMBER	2-2.5(x L)	2-5(x L)	2-10(x L)	2-25(x L)	2-50(x L)	2-100(x L)	2-150(x L)	2-200(x L)
Slit Width (μ m)	2.5	5	10	25	50	100	150	200
Tolerance (μ m)	+0.5/-0.1	± 1	± 1	± 2	± 2	± 4	± 4	± 4
Length:(mm)	3mm / 2mm / 1mm							
Material	Stainless Steel							

High Power Air Slit Aperture

- Finish: Gold plated one side, flat poly black (98% emissivity) on reverse side...
- Edge finish: < 50 μ -inch nominal
- Material: Copper
- Straightness: < 0.5 μ m per mm < 2 μ m per inch
- Diameter: 9.5377mm 3/8 inch (0.3755 inch, maximum)
- Positional tolerance: ± 0.006 inch (0.1524mm)
- Thickness: .001 in. (25 μ m)

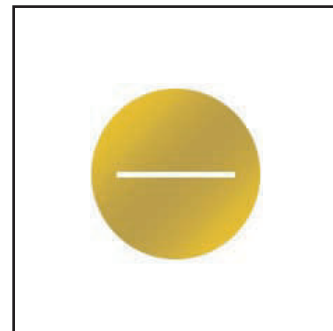

High Power Precision Air Slit						
Part No.	4-5 (x L)	4-10 (x L)	4-25 (x L)	4-50 (x L)	4-100 (x L)	4-200 (x L)
Slit Width (μ m)	5	10	25	50	100	200
Tolerance (μ m)	± 1	± 1	± 2	± 3	± 4	± 4
Length:(mm)	3mm / 2mm / 1mm					
Material	copper					