



M7 REMOTE Electric Trolley Instruction Manual

EN



Before using the M7 REMOTE for the first time, please take a few minutes to read through this manual to ensure that you get the most out of your trolley



REGISTER ONLINE
www.motocaddy.com/warranty

Visit www.motocaddy.com/instructions for other Motocaddy instructions including translations

Contents

Locating your Serial Number / Information about DHC	3	Unfolding & Folding your Trolley.....	14 - 15
Safe use of your Trolley.....	4	Upper & Lower Bag Supports.....	16
Safety Features.....	5	Adjusting the Bag Supports.....	17
Trolley Care.....	6	Equipment Overview.....	18
Battery Care & Advice.....	7	Remote Control Handset.....	19
Charging your Lithium Battery / Lithium Battery Care.....	8	Pairing the Remote Control / Handset Lock function.....	20
Lithium Battery Care.....	9	Operating the M7 REMOTE.....	21
Attaching the Wheels / Inverting the Wheels.....	10	Battery Meter / USB Charging Port.....	22
Attaching the Anti-Tip Wheel.....	11	Declaration of Conformity.....	23
Setting trolley to run straight.....	12 - 13		

Locating your Serial Number

The serial number for this M-Series trolley is located on the trolley underside next to the motor (fig. 1). This number is required when registering your warranty online and should be kept handy for future use.

The same number should also be on the box received with your trolley. Please ensure you keep hold of the packaging in case you need to return your trolley for any reason. A proof of purchase must also be kept in case your trolley requires servicing during its warranty period.



Fig 1

Please keep a record of your trolley serial number here for future reference:

M	C	M												
---	---	---	--	--	--	--	--	--	--	--	--	--	--	--

Information about DHC

The letters DHC stand for 'Downhill Control' and mean that your M7 REMOTE will maintain a controlled speed whilst travelling down hills. Whenever you are looking to move the trolley in manual mode, even if just to reposition it ready to use, always put it on a low speed setting to make it easier to steer.

Safe use of your Trolley

Safe use of your Trolley

The first time you use the M7 REMOTE, we would advise using it on an open area of grass. The trolley speeds and steering characteristics will vary depending on the surface. The M7 REMOTE will turn much quicker on hard, smooth surfaces and will behave differently on grass. You will also find that the weight of the golf bag will affect both speed and steering.

Motocaddy trolleys are designed for the transportation of golf bags and clubs contained within. Using the trolley for any other purpose may cause damage to the trolley and cause harm to the user. The following is not intended to cover all possible situations. Caution and common sense should always be used when operating the M7 REMOTE.

- Never aim the M7 REMOTE at other people or golf trolleys
- Do not attempt to transport any other equipment
- The trolley is not designed for the transportation of people
- Do not use the trolley to assist you when going up hills
- Submerging the trolley in water (e.g. a lake) is likely to cause damage to the trolley
- Do not operate the trolley whilst under the influence of drugs or excessive amounts of alcohol
- All batteries must be disconnected from the trolley before folding, storage and transportation
- When using the M7 REMOTE in confined spaces (for example car parks) or near water (such as over bridges) it is advisable to use the 'Manual' control mode to ensure that you remain in control of the trolley
- Never let the M7 REMOTE run out of your sight. Always use proper care and control

Motocaddy cannot take responsibility for any damage or injury caused from improper use.

Safety Cut-Off

The M7 REMOTE trolley is fitted with safety cut off features. Whilst operating the trolley via the remote control, if no command is sent to the trolley (any buttons pressed) for longer than 120 seconds, the trolley will stop.

Whilst moving, if the trolley travels out of range of the remote control, the trolley will also cut power to the motors.

Whilst operating the trolley in manual mode, if no adjustment to the speed is made via the dial for longer than 10 minutes, the trolley will stop.

If any of these safety features initiate, pressing the on/off button or the + button of the remote handset will restart the trolley.

Caring for your Trolley

Although your Motocaddy trolley has been weatherproofed, please follow these simple guidelines to help protect your trolley:

- Do not store your trolley outside
- Try to minimise exposure to rain as much as possible with an umbrella during heavy rainfall
- Wipe excess water from the trolley prior to storage
- Never use a pressure washer to clean your trolley. To prevent water damage, wipe down with a damp cloth
- Avoid using high pressure air hoses near moving components

This Motocaddy trolley is designed to require very little maintenance. We do however recommend giving your trolley regular checks to ensure:

- There is no build up of excess mud and dirt
- The front wheels are not clogged up and turn freely

Only original Motocaddy parts should be used when repairing your trolley.

Battery Care & Advice

All batteries must be charged as soon as possible after each use. Leaving batteries discharged for long periods of time will affect the battery life.

Please ensure that only batteries supplied by Motocaddy are charged with Motocaddy chargers. Cyclic battery chargers are designed specifically in accordance with the battery manufacturer's requirements. The Lithium battery charger MUST NOT be used to charge any other battery and is designed for use with Motocaddy Lithium batteries only.

The charger should only be connected to an earthed socket outlet; the battery charger should only be opened and maintained by authorised personnel. Unauthorised opening will invalidate your warranty.

The battery must be stored and charged on a dry non-carpeted surface and charged at temperatures ranging between 10°C and 30°C. Charging above or below these temperatures is not recommended as it can reduce the battery capacity.

When connecting your battery to the trolley, please ensure that the connections match up black to black and grey to grey.

Charging your Lithium Battery / Lithium Battery Care

Charging your Lithium Battery

1. Unplug the Lithium battery from the trolley. This should always be performed before folding the trolley to avoid damage to the battery and/or trolley
2. Plug the charger into your mains supply
3. Attach the battery cable to the charger matching black to black and grey to grey
4. When the charging LED indicator has turned green, the battery is fully charged and ready to be used

 RED - Battery charging   GREEN - Battery fully charged and ready to be disconnected

5. The charging process will take between 3 to 5 hours depending on the depth of discharge (please be aware that this may take longer for the first few charges)
6. Once charging is complete please disconnect the charger from the mains power supply
7. Finally disconnect the charger from the battery

If you connect the battery to the charger and the LED goes out, this is likely to indicate that the battery is fully charged. Please double check the battery on the trolley to ensure that it is fully working.

Caring for your Lithium Battery

- Try to avoid getting the battery too wet (i.e. do not submerge the battery, avoid deep puddles and do not clean your trolley whilst the battery is still in the battery tray)
- Dropping the battery may cause damage to the internal cells
- Do not lift or carry the battery by the cable
- Use a damp cloth to clean off any dirt

Recommendations for hibernation of Lithium Batteries during winter months

If for any reason your Lithium battery is not going to be used for lengthy periods, e.g. 3 months over the winter, it is advised to store the battery half charged. To do this simply use the battery for a round of golf as usual and charge it for 1.5 hours at the end of the round. Before the battery is used again, recharge it (top it up) prior to use.

We recognise that extended absences are not always planned in advance, however when it is likely that you will not be using your battery for a period of time it is good practice to follow these steps to extend the life of your Lithium battery. Please ensure that the charger is ALWAYS disconnected from the battery after charging.

Battery Management System (BMS)

Motocaddy Lithium batteries are fitted with a comprehensive battery management system (BMS) to protect the battery from excessive abuse, high currents, deep discharge and overcharge. When the battery is delivered there may be no output as the BMS is designed to maximize safety whilst shipping. Please ensure that the battery is fully charged prior to connecting it to your trolley as this will activate the BMS and effectively 'switch-on' the battery. From time to time, at deep discharge or long term storage the BMS may switch-off the battery. A full battery charge will rectify this problem.

Motocaddy golf trolleys are designed to work with the BMS system installed in the Lithium batteries and the voltage meter is also synchronised to work in conjunction with the battery. If for any reason the voltage on the battery falls below the low battery warning on the trolley, then the BMS may disable the battery to protect it. Again if this occurs please recharge fully. Please be aware that Lithium batteries tend to 'drop off' quickly at the end of the cycle so it is not advisable to attempt to play excessive holes as the BMS will activate for protection purposes.

Attaching the Wheels / Inverting the Wheels

Attaching the Wheels

The M7 REMOTE trolley does not have a specific left and right wheel.

To attach the rear wheels, follow these simple steps:

1. Push the quick release button in towards the centre of the wheel
2. Slide the wheel onto the trolley axle as far as it will go (onto the inner groove)
3. Once in position, release the button and pull the wheel outwards slightly to lock
4. An audible 'click' will confirm the wheel is in the correct position

The outer groove can be used as a "free-wheel" option if you run out of battery power.

To check you have attached the wheels correctly onto the inner groove, you will find they will not rotate freely in either direction.

Inverting the Wheels

The wheels can be inverted to reduce the trolley width for transportation and storage.

1. Push and hold the quick release button while sliding the wheel off the axle
2. Flip the wheel over, push and hold the button, then slide onto the axle
3. Release the button and pull the wheel out slightly until it engages with the free wheel groove

Attaching the Anti-Tip Wheel

The Anti-Tip wheel is designed to prevent the trolley from tipping backwards on steeper inclines and it is recommended that the wheel is ALWAYS fitted when navigating using the remote control handset.

To attach the wheel, simply pull the grey button on the right-hand side out and slide the wheel attachment into the housing. There will be a 'click' when the wheel is fitted securely in place.

To remove the wheel, pull the grey button out and slide the attachment out of the housing.

The Anti-Tip wheel can be removed for cleaning and storage purposes.

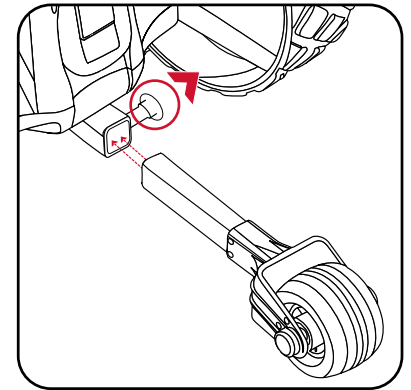

Setting trolley to run straight

Adjusting the Front Wheel Alignment

If your trolley is not running in a straight line, there are a couple of adjustments that can be made. This problem can be caused by a number of factors including a slightly loose bag support or an unevenly packed golf bag. The first thing to alter is the alignment of the front wheel. This is to be completed on a flat level surface whilst using the trolley in remote mode then follow these steps:

1. Rotate the front wheels 180° to allow access to the quick release lever (fig. 1)
2. Pull down the quick release lever (fig. 2)
3. There are two small metal dials on either side of the housing that are used to realign the wheel (fig. 3)
4. If your trolley is veering to the right, you will need to turn the left hand dial clockwise and the right hand dial anti-clockwise
5. If your trolley is veering to the left, you will need to turn the right hand dial clockwise and the left hand dial anti-clockwise
6. Push the quick release lever back up until it firmly clips in to place (fig. 4)
7. Rotate the wheel back 180° so that it sits underneath the housing (fig. 5)

This procedure can be carried out until the trolley is moving in a straight line (you may only need to adjust one dial at a time).

These instructions are based on being in front of the trolley looking at the wheel whilst it is in front of the housing.

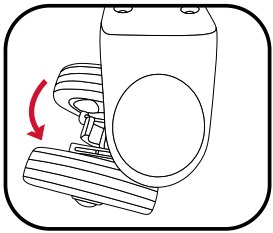

Fig 1

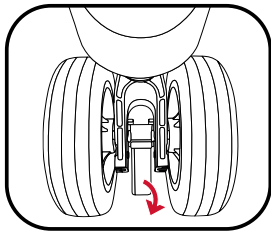

Fig 2

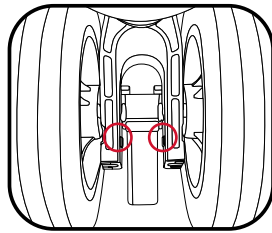

Fig 3

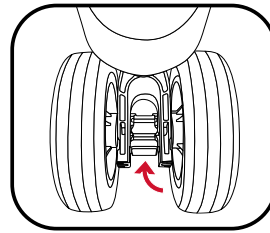

Fig 4

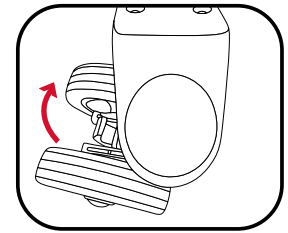

Fig 5

Troubleshooting

If the trolley is now running straight in remote mode but not in manual mode then the motors will need trimming. To do this follow these steps:

1. The trolley should again be on a flat level ground,
2. Press and hold the On/Off button for 4 seconds, the speed display will show "0"
3. Turning the dial either clockwise or anti-clockwise will then change the display to show 1-9, turning the dial anti-clockwise will trim the trolley left and turning the dial clockwise will trim the trolley right
4. Start by trimming gradually (1-3). After the value is adjusted, press the button to return to normal operation
5. Then press the button to start the trolley, check to see whether the trolley has been trimmed enough, if it hasn't and is still not running straight, repeat the procedure and increase the value the trolley is trimmed to

Unfolding your Trolley

Unfolding your Trolley

We recommend unfolding your trolley once the wheels have been un-inverted and reattached (see page 10).

1. Lift the upper bag support slightly and release the upper latch (fig. 1)
2. Unfold the handle and re-secure the latch (fig. 2)
3. Release the lower latch (fig. 3)
4. Lift the trolley handle up into position (fig. 4). The front wheel will automatically unfold
5. Re-secure the lower latch and ensure the auto-open stand is folded away (fig. 5)
6. Insert anti-tip wheel (see page 11)

The model shown below is a standard M-Series trolley. The folding mechanism is the same despite the design differences.

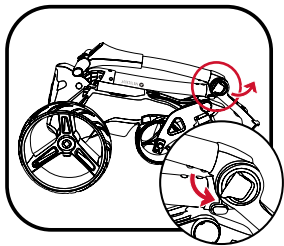

Fig 1

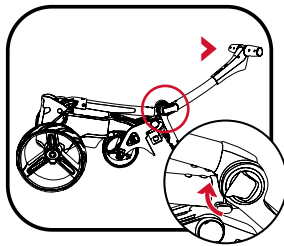

Fig 2

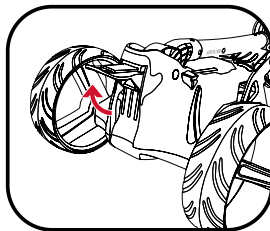

Fig 3

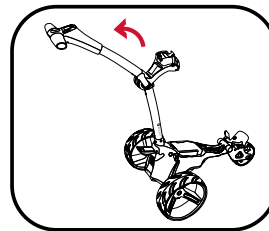

Fig 4

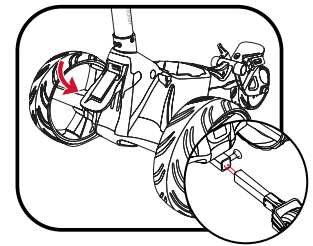

Fig 5

Folding your Trolley

1. Release the lower latch (fig. 1). The auto-open stand will also be activated
2. Fold the frame forward until fully extended (fig. 2). The front wheel will automatically fold underneath
3. Release the upper latch and fold the handle back until the trolley is fully folded (fig. 3)
4. Re-secure both latches. If you wish to stand the trolley upright, leave auto-open stand out. Remember to ensure the auto-open stand is pushed down if not being used (fig. 4)
5. The wheels can be inverted to reduce the trolley width for transportation and storage (fig. 5). See page 10 for details

Please ensure the auto-open stand is folded away when not in use to prevent damage. The anti-tip wheel will need to be removed if you are planning on standing the trolley upright for storage.

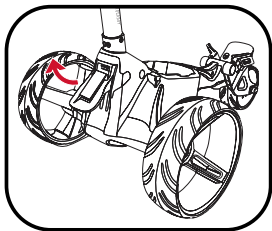

Fig 1

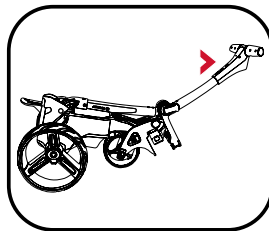

Fig 2

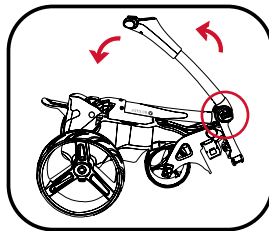

Fig 3

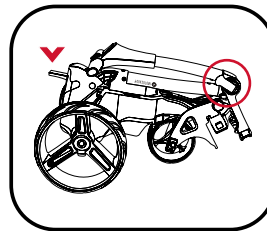

Fig 4

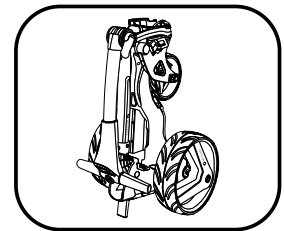

Fig 5

Upper & Lower Bag Supports

Upper Bag Supports

The upper bag support straps are secured using the following steps:

1. Stretch the elasticated strap around the bag & loop the rounded bar underneath the hook (fig. 1)
2. Position the two placement straps centrally on your golf bag (fig. 2)

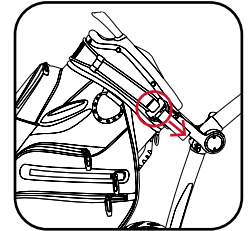

Fig 1

Lower Bag Supports

This Motocaddy trolley is fitted with the EASILOCK™ bag attachment system.

If you are using an EASILOCK™ compatible golf bag please follow these simple instructions:

1. Remove the two pre-fitted lower bag straps by depressing the rear button and sliding (fig. 3)
2. Match up the indicating line on the golf bag with the line on the lower bag support
3. Lower the bag until the pins lock in position. You should hear an audible 'click'

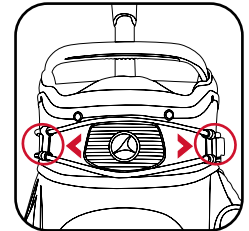

Fig 2

If you are using a non-EASILOCK™ golf bag, please use the following instructions:

1. Stretch the lower bag strap around the bag base & loop the rounded bar underneath the hook
2. Position the two placement straps centrally on the base of your golf bag

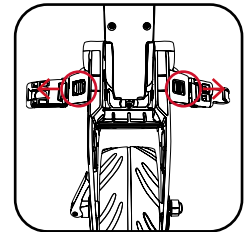

Fig 3

Please ensure all straps are hooked securely before releasing. Failure to do so could result in injury.

Adjusting the Bag Supports

The bag support straps are manufactured from elasticated material to allow your golf bag to be held tightly in position.

The strap should be adjusted to be reasonably tight around the golf bag:

1. Unclick the elasticated straps from the housing by pulling outwards in the direction shown (fig. 1)
2. Move the bar as required to tighten or loosen the strap fitting. Pulling the bar downwards will tighten, pushing it upwards will loosen (fig. 2)
3. Ensure that the straps are clipped back into the housing before use (fig. 3)

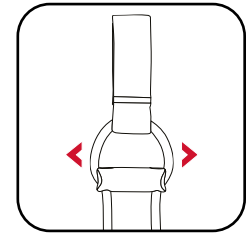

Fig 1

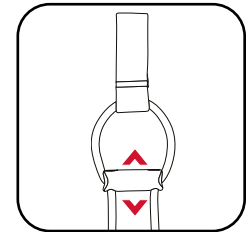

Fig 2

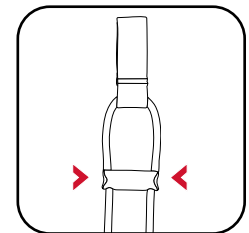
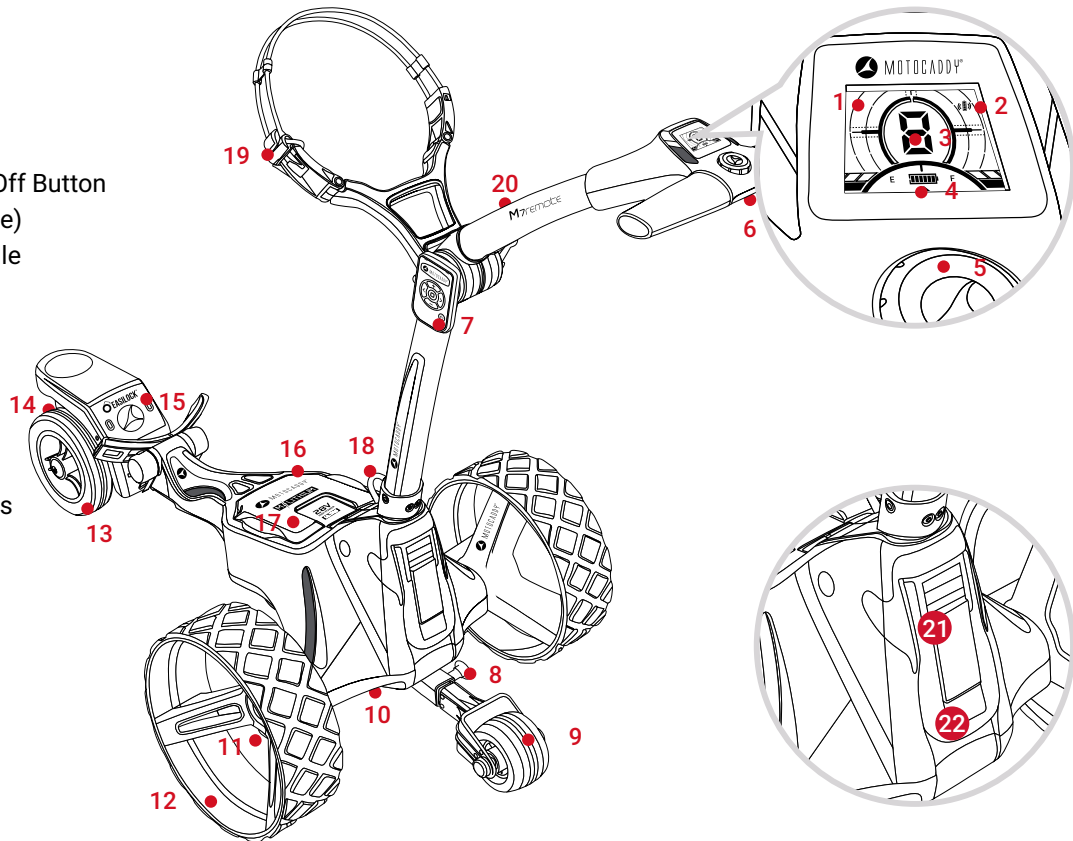

Fig 3

Equipment Overview

1. LCD Digital Display
2. Remote Handset Battery Meter
3. Speed Setting
4. Trolley Battery Meter
5. Manual Speed Controller & On/Off Button
6. USB Charging Port (under handle)
7. Remote Control Handset & Cradle
8. Anti-Tip Wheel Release
9. Anti-Tip Wheel
10. Motor (under Battery Tray)
11. Rear Wheel Release Button
12. Rear Wheels
13. Front Wheels
14. Front Wheel Alignment Adjusters
15. EASILOCK™ Lower Bag Support
16. Battery Tray
17. Battery
18. Battery Connector
19. Upper Bag Support
20. Upper Release Latch
21. Auto-Open Stand
22. Lower Release Latch



Remote Control Handset

1. Indicator LED
2. Plus (+) Button
3. Stop Button
4. Right (>) Button
5. Minus (-) Button
6. Lock Button
7. Left (<) Button
8. Charging Port

The remote handset contains a rechargeable Lithium battery. The handset can be recharged using a mini USB cable (supplied), the charging port is located under the rubber flap at the base of the handset.

The green LED on the handset will flash whilst being charged, once it is fully charged the green LED will be on and not flashing. This will take around 4-5 hours to fully charge from flat.

When the handset battery starts to get low, the LED will flash red when pressing a button. Should the battery go completely flat there will be no LED when pressing a button. Should this happen, the trolley will stop. You can recharge the handset using the USB port on the trolley.

Please be aware that charging the remote handset through the USB port will take power from the main trolley battery and prolonged charging will reduce the trolley battery capacity between charges.

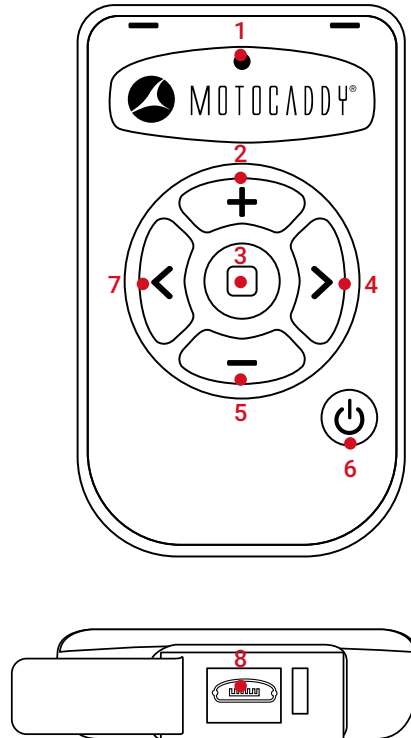

Pairing the Remote Control / Handset Lock function

Pairing the Remote Control

In the unlikely event that the remote is not responding or you have a new remote handset, it will need to be paired to the trolley.

To pair the remote to the trolley:

1. Press and hold the stop button on the remote handset for 5 seconds (fig. 1a)
2. The LED on the handset will start flashing green (fig. 1b), at this point release the button and plug the battery into the trolley
3. If the trolley is not powered on within 60 seconds, the handset will exit pairing mode

Handset Lock function

The remote handset can be locked by pressing the Lock button (fig. 2a), when this is pressed the LED will either flash Green or Red (fig. 2b). Green indicates that the handset is unlocked and Red indicates that it is locked.

When it is locked the +/-/< & > buttons will be disabled and a Red LED will flash when they are pressed, the Stop button will still operate and show a Green LED when pressed.

If the handset is locked whilst the trolley is running in remote mode, the trolley will stop after 4 seconds as the handset will stop sending a signal. If the trolley is in Manual mode it will continue to run but can still be stopped using the stop button of the handset.

Pressing the Lock button again (fig. 2a) so the LED flashes Green (fig. 2b), will unlock the handset and all buttons will be enabled.

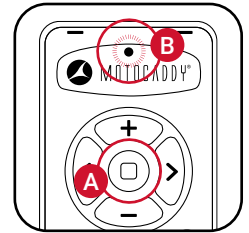

Fig 1

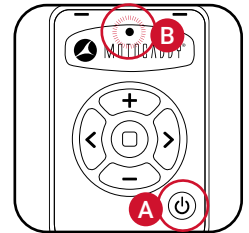

Fig 2

Operating the trolley using the Remote Control handset

When the battery is first plugged in to the trolley the speed display will show 2, this is the default speed that the trolley will always start at after it has been stopped.

To start the trolley, press the 'Plus (+)' button on the remote control handset. The 'Plus (+)' and 'Minus (-)' buttons can then be used to increase and decrease the speed to the required pace, the current speed will be shown on the display.

The 'Left (<)' and 'Right (>)' buttons are used to steer the trolley, a quick press of the button will adjust the direction slightly at the current speed, a longer press of the left and right buttons will reduce the speed to turn the trolley, it will gradually increase the sharpness of the turn the longer the button is held. Release the button and the trolley will return to the original speed it was going.

The trolley can be stopped quickly by pressing the stop button or gradually by decreasing the speed until it stops, the lowest speed setting in remote mode is 2, once you slow to speed 2 decreasing the speed once more will stop the trolley.

When the trolley is stationary, pressing and holding the 'Minus (-)' button will put the trolley into reverse. Releasing the (-) button will stop the trolley. The trolley will only reverse at one speed and cannot be steered whilst reversing.

Operating the trolley using Manual Control mode

The M7 REMOTE can also easily be used in manual mode. When the trolley is stationary, simply turn the dial to select the desired speed and press the button to start the trolley. You can also switch from remote mode to manual mode whilst the trolley is moving. Simply turn the speed dial and the trolley will respond to the selected speed.

Whilst using the trolley in manual mode, you can quickly take control again using the remote by pressing either the 'Plus (+)' / Left or Right Buttons, it can also be stopped with the stop button. Pressing the Minus button will decrease the speed but will leave the trolley in manual mode.

Battery Meter / USB Charging Port

Battery Meters

The M7 REMOTE includes two on-screen battery meters which provide an indication of trolley (fig. 1a) and handset (fig. 1b) battery capacity. The number of illuminated bars will decrease as the battery capacity reduces.

A fully charged trolley battery will show two red and four green bars.

The trolley is designed to protect your battery from being fully discharged, should your battery capacity drop too low the trolley will cut the power to the motor. If this should happen you will see the battery meter flashing on screen (fig. 2 & 3). Please charge your Lithium battery before further use.

Please be aware that certain moisture, temperature and humidity conditions can result in localised misting within the display screen. This will not affect the trolley functionality, nor cause any damage and will return to normal when adverse conditions subside.

USB Charging Port

This trolley features a USB charging port designed to charge USB powered devices during your round.

Simply remove the covering cap and plug a USB cable into the charging port located on the underside of the handle. The device will continue charging while the cable is attached and the battery is connected.

The rate of charge will be slower than a mains AC charger and similar to plugging the device into a PC. The USB charger takes power from the main trolley battery and continuous charging will reduce the battery capacity between charges. The trolley is designed to disable the USB port when the battery capacity reaches a preset level.



Fig 1



Fig 2



Fig 3



DECLARATION OF CONFORMITY

ORIGINAL

Business Name and Full Address of Manufacturer

Motocaddy Ltd - Units 15-18 Stansted Distribution Centre,
Start Hill
Great Hallingbury

Hertfordshire
CM22 7DG

Name and Address of Authorised Representative

-

Name and Address of the Person in Community Authorised to compile the Technical File (if different to above)

-

Description of product (Commercial Name)

Motocaddy Electric Trolley

Function, Model, Type, Serial Number

Function: Electric Trolley

Model: S1/S1 DHC/S3 PRO/S3 PRO DHC/
S5 CONNECT/S5 CONNECT DHC/S7 REMOTE/
M1/M1 DHC/M3 PRO/M3 PRO DHC/
M5 CONNECT/M5 CONNECT DHC/M5 GPS/
M5 GPS DHC/M-TECH/C-TECH/M7 REMOTE

Type: Motocaddy Digital Range

Standards Used

BS EN ISO 12100 2010

Place of Declaration

Units 15-18 Stansted Distribution Centre,
Start Hill
Great Hallingbury

Hertfordshire
CM22 7DG

Date of Declaration Wednesday January 01, 2020

Declaration

I declare that the machinery fulfils all the relevant provisions of the following Directives:- Low Voltage Directive 2006/95/EC, Electromagnetic Compatibility Directive 2004/108/EC.

Person Empowered to Draw Up Declaration

Name: John Helas

Position: Managing Director

Signature:



Motocaddy Ltd, Units 15 - 18 Stansted Distribution Centre,
Start Hill, Great Hallingbury, Hertfordshire, CM22 7DG, United Kingdom

t: +44 (0)1279 712 370 e: info@motocaddy.com w: www.motocaddy.com



We are dedicated to protecting the environment and encourage the recycling of Motocaddy products through a free collection and disposal service. To find out more or to locate your nearest Motocaddy recycling point, please contact us through our website.

MC.20.64.001

EASILOCK™ Patent (GB) - GB2519073
USB Charging Port Patent (GB) - GB2473845
USB Charging Port Patent (AUSTRALIA) - 2010224448