

POMPA HYPERFLUSH 36



Certificata
UNI EN ISO 9001:2015

MANUALE D'USO USER MANUAL

MANUAL INDEX - ORIGINAL INSTRUCTIONS

1.0 General information for users.....	18
1.1 UE conformity statement.....	18
1.2 Guarantee terms and conditions.....	19
1.3 General and safety warnings.....	20
2.0 Technical data.....	22
3.0 Exploded view.....	23
4.0 Assembly and usage.....	24
4.1 Hoses connection.....	24
4.2 Power flushing procedure.....	24
4.3 Descaling procedure.....	26
5.0 Pump maintenance.....	27
5.1 Maintenance after power flushing operations.....	27
5.2 Maintenance after descaling operations with acidic products.....	27
6.0 The environment.....	28
6.1 Packaging disposal.....	28
6.2 Product disposal.....	28

1.0 GENERAL INFORMATION FOR USERS

1.1 UE conformity statement

DECLARES

This product HYPERFLUSH 36 has been designed and constructed in accordance with the following European directives (including all applicable amendments):

Direttiva 2006/42/CE : Machine
Direttiva 2014/35/UE : Low Voltage
Direttiva 2014/30/UE : Electromagnetic Compatibility
Direttiva 2011/65/CE : RoHS

We also declare that the product conforms to the following standards:

EN 60335-2-41:2003, A1:2004, A2:2010 with
EN 60335-1:2012, A11:2014, A13:2017
EN 55014-1:2017
EN 55014-2:2015
EN 61000-3-2:2014
EN 61000-3-3 :2013
IEC 62321:2008
IEC 62321-3-1:2013
IEC 62321-5:2013
IEC 62321-4:2013
IEC 62321-6:2015
IEC 62321-7-1:2015
IEC 62321-7-2:2017
EN 50564:2011

Place: Santa Maria di Zevio (VR)
Data: 10/10/18

Company director - Mr. Giordano Cavalli

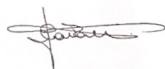

1.2 Guarantee terms and conditions

ENG

Limits:

The warranty is limited to the supply or repair of defective parts or materials that must be returned at the customers cost to the local merchant's address. The warranty does not cover damage resulting from misuse, inappropriate use of chemicals, and normal wear due to usage.

The guarantee is void in case of disregard to maintenance and safety instructions in this manual.



Viale Archimede n. 45, 37059 - S. Maria di Zevio - Verona
tel. 045 8731511 fax 045 8731535

www.mantaecologica.com - e-mail: info@mantaecologica.com

1.3 General and safety warnings

WARNING! Equipment for professional use only!
Essential to read these instructions prior to use:

This equipment complies with current safety standards. However, improper use can cause damage to persons and/or properties.
Before using the pump for the first time, read this instruction booklet, as it contains important information on safety, operation and maintenance of the machine. In this way you avoid any risks to people and potential property damage.
The manual is intended both for users and pump technical maintenance professionals as indicated. Before performing any operations, both users and qualified repairers must carefully read the instructions contained in this publication.
Users can only carry out relevant operations described in this manual and must not attempt any extraordinary maintenance which is strictly the duty of qualified technicians. Failing to comply with these warnings may result in guarantee being void.
Keep these instructions and make sure that are read by all users.

Technical safety:

In case of descaling operations in combination with acidic products, start the pump only when it is connected to the equipment to be descaled. Moreover, avoid pump transport and handling with the acid inside the tank.
Before installing the machine, check that there is no visible damage. Do not install or operate the pump if any damage is detected.
Start the pump only when it is connected to the system to be descaled.
The electrical safety is only ensured if the machine is connected to a power supply that conforms with the EU safety standards and suitable for technical features as in this manual. If in doubt do not start the machine and seek advice from an electrical professional.

Use personal protective equipment (PPE):

- use acid-resistant goggles (in case of descaling operations);
- use acid-resistant gloves (in case of descaling operations);
- wear safety shoes (to prevent electrocution)



indicates a warning, a note of key functions, or useful information. Give full attention to blocks of text indicated by this symbol.



Indicates that a manual adjustment may also include the use of portable equipment or tools.



Risk of danger for the user.



Prohibited.

Correct usage:

The HYPERFLUSH 36 power flushing pump is built and designed to offer the user reduced weight and dimensions and safety performance, combined with high flow rate capabilities. It is fitted with handy wheels for easy movement, handling and positioning.

The pump is suitable for cleaning, restoring and desludging of heating and cooling systems, both conventional and underfloor of any type of plastic and metal, and systems that are clogged with sludge, limescale, swarf and/or corrosion.

The structure is made of impact-resistant reinforced polyethylene single tank, with vertical axis pump and reinforced recirculation hoses. Three-way valve for rapid mode exchange is used with a flow inversion device for optimum desludging efficiency and PVC fittings for durability.

The power flushing pump is simply connected into the central heating system, either across the standard circulator pump couplings, across the tails of one radiator, or wherever most practicable. The powerful flow will dislodge and mobilize deposits and corrosion which resist traditional system cleaning methods. Once the corrosion and sludge deposits have been loosened and mobilized, fresh clean water is forced through the central heating system, pushing the contaminated water out through the dump outlet to waste.

The pump can also be used for the addition of additives (ABSOLUTELY ORGANIC SOLVENT FREE AND ALCOHOL) and anti-freeze fluids in heating and cooling systems.

ENG



Tank lid must be loosened, during descaling operation, in order to allow correct tank venting.



Do not expose pump to strong heat, lamps and open flames.
Do not leave the HYPERFLUSH 36 unattended while working.



Before inserting the plug into the mains supply check that the switch is off.
Also make sure that pump body is correctly tightened to the tank and all the hydraulic connections are in order.



Maximum operational time (continuously) should not exceed 2 hours.
Please allow 1/2 hour before resuming operations.

Shut firmly with supplied stoppers pump hoses when finished operations and disconnect pump, in order to prevent chemicals spillage.

2.0 TECHNICAL DATA

MODEL	Hyperflush 36
Single phase electric motor	230 V-50 Hz
Weight	17 Kg
Max. flow rate	50 l/min
Head	16 m
Connections (in/out)	3/4"
Tank capacity	36 litres
Min/max. temp.	5 / 70 °C
Power	0.373 kW
Dimensions	(H) 630 mm (L) 350 mm (P) 350 mm

3.0 EXPLODED VIEW

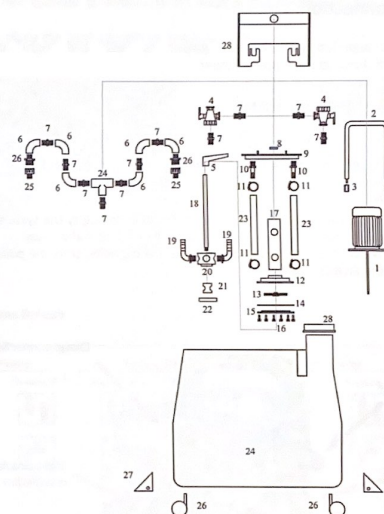

1. Motor
2. Handle
3. Plastic nut
4. 3-way ball valve 3/4"
5. Flow inverter lever
6. Elbow 3/4"
7. Nipple PP NFV 4/4"
8. Oil seal
9. Cover
10. Hose connector
11. Hose clamp
12. Impeller housing
13. Impeller
14. Gasket
15. Impeller cover
16. Plastic screw M6 x20
17. PP tube
18. Inverter shaft
19. Hose holder D. 75mm
20. Inverter cylinder
21. Inverter piston
22. Inverter cover
23. Silicon tube
24. Tank
25. 1" Connector
26. Wheels
27. Inox plates
28. Carter

4.0 ASSEMBLY AND USAGE

4.1 Hoses connection

Connect hoses supplied with lid and gasket, to "left" and "right" circulation. Connect the third hose to the nipple of dump.

4.2 Power flushing procedure



Check if all connections and hoses are correctly tightened.

Prior to commencing the treatment, it is advisable initially to empty the system and refill it with clean water in order to drain most of the contaminated water away. Open the clean water inlet and fill the tank to the 3/4 capacity, start the pump and set 3-way valve to the DUMP position.

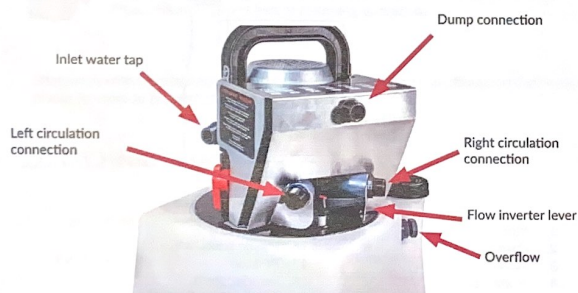

After flushing the system adequately, set the valve into CIRCULATION mode (see image above).

Wheels assembly

ENG

Use a 13 mm spanner to screw wheel's shaft in the housing. Do not apply excess of torque. Be sure to place the bent corners on the tank side.



Instructions for use

Water Washing		Chemical Washing		Water Rinsing		Inhibitor
Flushing L	Flushing R	Recirculate L	Recirculate R	Flushing L	Flushing R	Recirculate
Risciacquo Sx	Risciacquo Dx	Ricircolo Sx	Ricircolo Dx	Risciacquo Sx	Risciacquo Dx	Ricircolo
Lavaggio con acqua		Lavaggio chimico		Lavaggio con acqua		Inibitore

With the pump running, add the cleaning chemical agent (for dosage please read technical data sheet/label of product). In order to maximize the cleaning agent distribution, reverse the flow direction by way of the manual lever on the pump, roughly every 10 minutes.

Proceed with cleaning for 4 to 6 hours dependent on the level of contamination (please respect the operational time - see paragraph 1.3). Cleaning can be carried out both with the boiler off and with heating on (preferably on since the heat accelerates the process without exceeding 70°C as the cleanser could act too quickly and potentially cause clogging. Do not leave the boiler firing continuously.

Once the cleaning operation is completed and with the pump still set on the 3-way valve in DUMP mode, add clean water to make up the water level inside the tank and hence avoid emptying the system.

When the water circulating appears to be perfectly clean with no traces of impurities visible, reset the 3-way valve in the CIRCULATION mode and start adding the corrosion inhibitor in order to prevent any new formation of sludge, limescale and clogging (check the product technical data sheet/label).

Keep the circulation going, until the electric conductivity of the water inside the tank settles (check this with a conductivity meter).



After the addition of the inhibitor, disconnect the pump taking care of not spilling chemicals on the ground or things.

ATTENTION: In order to prevent the tank from overflowing, it is necessary to balance the flow and return. This can be done by partially shutting either the flow valve (position number 2) or the 3-way valve (position number 3), depending on the flow direction. It is also suggested to carry out the cleaning by flushing each radiator individually, or section the system, if possible, so as to



In the case of excessive formation of foam whilst cleaning, switch off the pump and wait until the foam subsides. Dilution of the solution with water may be necessary if foaming persists.

4.3 Descaling procedure

In case of pipework descaling, first check if the minimum flow rate is available for the acidic solution to circulate, otherwise the operation will not be possible.



Disconnect the flow and return of the equipment to be descaled, empty all the water inside, and finally connect the pump with the supplied hoses.

Open the tank and then add half a tank of water (please notice that operational temperature during descaling must never exceed 70 °C).

Connect the pump to the mains and switch it on and slowly start adding the descaling chemical, until the required concentration is obtained. This operation will allow the correct product mix for optimum performance.

Please follow the information on the technical data sheet/label of the product.

In order to maximize the cleaning agent distribution, reverse the flow direction by way of the manual lever on the pump, roughly every 10 minutes.

In the case of excessive formation of foam whilst cleaning, switch off the pump and wait until the foam subsides. Dilution of the solution with water may be necessary if foaming persists.

After the descaling process, drain the acidic solution, flush the descaled equipment thoroughly with water and then with an alkaline solution (neutraliser).

5.0 PUMP MAINTENANCE

5.1 Maintenance after powerflushing operations

NB: The HYPERFLUSH 36 is also suitable for the use anti-freeze fluids. In case of internal leak sealers always flush with plenty of water after operation in order to avoid encrustations, blockages and potential damage.

Importante: at the end of working day always carry out a meticulous washing of the pump and filter with clean water for at least 10 minutes, to remove dirt or other impurities and to extend the life of the unit.

Dispose of any discharges whilst conforming with any relevant local regulations.



In some instances of older and compromised systems, a few days after the cleaning operation some leaks may appear. Proceed with the addition of internal leak sealer product (for application and dosage please read the technical data sheet/label of the product) and then look to replace the parts that are leaking as soon as possible.

5.2 Maintenance and neutralisation of the acid solutions

Once the descaling process is over, switch off the pump and unplug from the mains. Wait until the solution inside the descaled equipment has completely returned into the pump tank. Do not leave the pump unattended whilst working.



As for the descaled equipment the pump will also require an acidic solution neutralization. Check that the pH value is between 6,5 and 9,5. For the safe and correct result, we recommend to use an approved neutralizing chemical. Flush the pump body and tank thoroughly with water. The water produced from the descaling operation and the water used for rinsing, must be disposed of according to local regulations.



ATTENTION: Failing to comply with these warnings will result in the guarantee being void.

6.1 Packaging disposal

Packaging is devised to protect machine during transport.

Materials used have been selected according to the environment respect and ease of disposal, hence being recyclable.

6.2 Product disposal

Pursuant to the European Directives 2012/19/EC on the restrictional use of hazardous substances in electric and electronic equipment and on the disposal of waste material. The crossed out wheellie bin symbol applied to the equipment or packaging means that the product should be collected separately from other types of waste at the end of its useful life.

User shall convey machine that has reached the end of its life cycle to an appointed separate collection site for obsolete electric and electronic equipment.

Correct separate collection and the subsequent recycling, treatment and environmentally compatible disposal of discarded equipment is of aid in avoiding possible negative effects for the environment and people's health and facilitates the re-use or recycling of the materials of which the equipment is made.

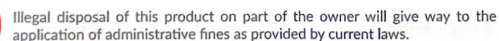

NOTE

This image shows a single sheet of white paper with horizontal blue or grey ruling lines. The lines are evenly spaced and run across the width of the page. There are no margins, text, or other markings on the paper.