



## Durable, reliable engineering

Every aspect of this impressive engine is built to last, precision engineered for the ultimate in durability and reliability so the fun keeps flowing.

Stylish XTO inspired looks cover a wealth of outstanding technical design, with every aspect of air intake, displacement and combustion optimisation exploited, for raw power and top speeds that will take your breath away.

Used alone or in combination to power larger craft, this premium engine delivers that must-have trifecta of responsive handling, rapid acceleration and ultimate reliability.



- Fully compatible with Helm Master EX® with Autopilot and integrated bow thruster.
- Built-in Digital Electric Steering (DES) on Steer by Wire engines.
- Lightest weight in class.
- Thrust Enhancing Reverse Exhaust (TERE) for outstanding reverse thrust and control when manoeuvring.
- Durable lower unit.
- Elegant, sleek, and lightweight design.
- TotalTilt™ function with integrated tilt limit for effortless trailering and convenience when tilting.

## Durable, reliable engineering

The higher power and pure performance of this engine are perfectly balanced to deliver an unrivalled thrill. But it's not all about acceleration and high speeds. The increased torque at lower speeds allows for a more responsive, exhilarating experience when piloting the boat.

The 350hp V6 isn't just an adrenaline pumping powerhouse. It's also fully compatible with Helm Master EX® allowing you access to leisure-friendly features such as Autopilot so that you can take in the view, enjoy the sun and sea breeze. There's also an integrated bow thruster for added boating confidence, plus better control for larger craft.

The 350hp V6 is packed with exciting and Yamaha exclusive features, including Digital Electric Steering (DES), TotalTilt function and Thrust Enhancing Reverse Exhaust (TERE), delivering an even higher level of specification for these premium outboards.



## Compatible with Helm Master EX®

Yamaha's exclusive, category defining Helm Master EX® boat control system makes boat operations both easy and enjoyable. Helm Master EX® uses sophisticated technology to help you to boat with confidence, maximising fun on the water across both single and multiple outboard engine set-ups.



## Built-in Digital Electric Steering (DES)

Forget pumps, tripping over hoses, extra control units, the need for fluid filling (and the inevitable clean-up!). Yamaha DES keeps your bilge clean and spacious.

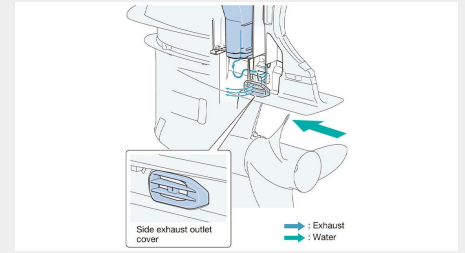

## Thrust Enhancing Reverse Exhaust (TERE)

Enjoy a stronger reverse and better low-speed manoeuvring – TERE keeps exhaust bubbles out of the propeller when in reverse. The prop bites only bubble free water, resulting in outstanding reverse thrust and control.

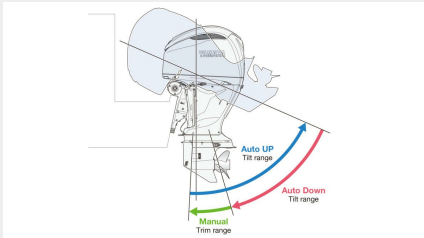

## TotalTilt™ function with integrated tilt limit

Yamaha's exclusive TotalTilt™ function allows a complete tilt up or down from any position with a simple double-push of a button. When the engine is moving, a buzzer sounds to alert crew to keep clear, and the integrated tilt limiter helps to prevent inadvertent damage.

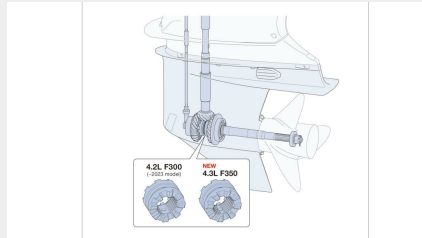

## Ultra-durable lower unit

Durable premium materials and robust designs come together to create a lower unit that will stand the test of time, even when pushed to the limit.



## Lightest weight in class

Feel the full benefit of the 350hp V6's impressive power advantages, thanks to the lighter weight that extra horsepower really counts.

## Engine

Engine type	4-stroke;DOHC
Bore x stroke	96.0 x 98.0 mm
Displacement	4256 cm <sup>3</sup>
Prop shaft output at mid range	257.4 kW (350hp) @6,000 r/min
Full throttle operating range	5,000 – 6,000 r/min
Carburettors	Fuel Injection
Lubrication system	Wet sump
Ignition / advance system	TCI
Gear ratio	1.75 (21/12)
Starter system	Electric
No. of cylinders/configuration	60-deg. V6
Fuel Induction System	EFI

## Dimensions

Oil pan capacity	7.9 L / 7.6 L *with/without oil filter exchange
Weight without propeller	293 kg – 304 kg

## Additional Features

Lighting Coil / Alternator	70 A (max) (battery charging: 55 A)
Throttle and shift controls	Digital electronic remote control
Trim & tilt method	Power Trim & Tilt
Full tilt up angle	69
Propeller	Optional
YCOP (Immobilizer)	Applicable
Counter Rotation Model	Available
Variable Trolling RPM	With DN Gauges
Dual Battery Charging System	Optional
Shift Dampener System (SDS)	Optional
Control	Drive By Wire (DBW)
Engine immobiliser	YCOP optional