

## MINI COLLECTION AND PUMPING STATIONS FOR WASTE WATER

The **VACUSYSTEM 170s** are pre-assembled, ready-for-use automatic pumping stations, designed for the disposal of waste and sewage water.

Particularly suitable when the water from drains is collected at a lower level than the main sewer. Design Features

- The standard pumping station consists of:

**- Tank**

In polyethylene with a capacity of 170 litres with screw-down lid. Three possible types of inlet for water collection or ventilation pipe inlet and cable glands for the electric pump power supply cable and service cables (overflow float on request).

**- BIOX Submersible Pump**

Models 200/8 AUT, 300/10 AUT, 400/12 AUT with cast steel impellers .

**- PVC 2" Ø Delivery Pipe**

**- PVC 2" Ø 90° Bend**

**- Plug**

with built in thermal protection and manual/automatic switch.

**Electric Pump Motor**

- Dry motor
- Single phase power supply with capacitor permanently activated and thermal protection built into the motor winding
- Level of protection IP68
- Class F insulation
- Speed of rotation 2850 rpm
- Completely insulated cable connection chamber

**Usage Limitations**

- Type of liquid: sewage water, with suspended solids of a maximum dimension of 40 mm
- Maximum liquid temperature 50°C

**Accessories (only on request)**

- Screw-down tank extension (see page 213)
- Threaded ball check valve 2" F (see page 213)
- Ball valve with threaded full bore 2" F (see page 213)
- Overflow float (see page 215)



### MOTOR PUMP INCLUDED

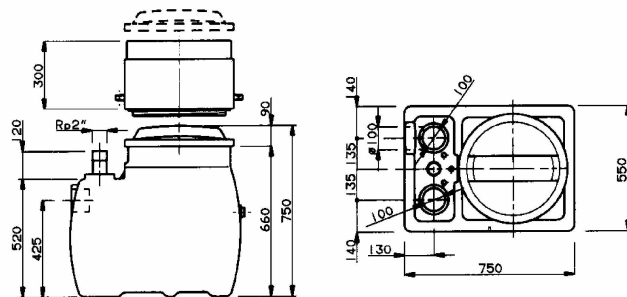
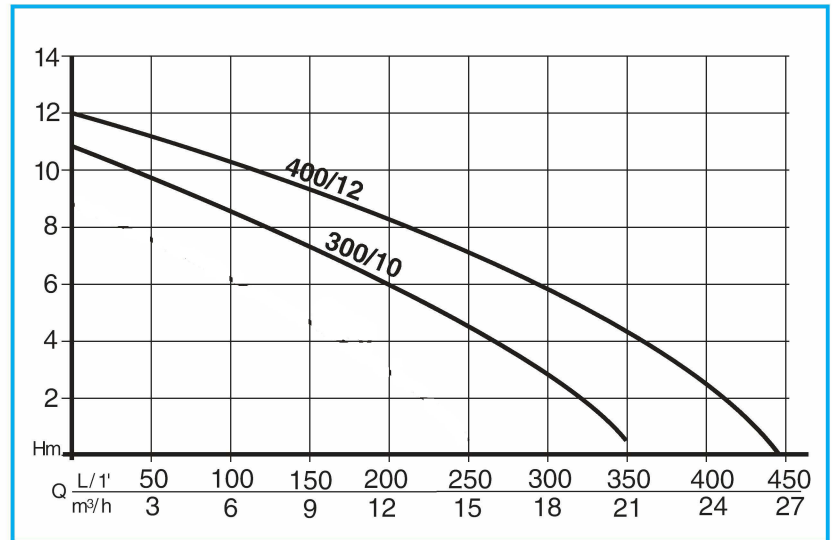

CODE	MODEL	Nominal Power		Absorbed Power		VOLTAGE	Amp.	µF.	Q	Discharge Head in meters								
		HP	kW	HP	kW					L/1'	50	100	150	200	250	300	350	400
									m³/h	3	6	9	12	15	18	21	24	
N2141040	VS 170-B 300	1,2	0,9	1,7	1,3	1 ~ 220 ÷ 240 V	5,8	20		9,8	8,7	7,5	6,3	4,7	3	0,5		
N2141050	VS 170-B 400	1,6	1,2	2,2	1,6	1 ~ 220 ÷ 240 V	7,2	20		11,2	10,4	9,3	8,3	7,1	5,8	4,2	2,5	