

Type: GS1500

1¼" Grinder pump - 230V



Performance

Liquid	Waste water
Capacity	150 l/min (9 m3/h)
Delivery head	25m

Technical details

Delivery connection	1¼" female thread
Nett Weight	35 kg
Gross Weight	36 kg
Dimensions	565 x 180 x 315mm

Motor

Absorbed Power (P1)	1.5kW
Rated Power (P2)	1kW
Nominal current	9.9A
Protection class	IP68
Power cable	10m H07-RNF
Voltage / phase / Hz:	230V / 1-Phase / 50Hz
Motor protection	Thermal

230V / 50Hz
Grinder pump

Usage:

- Sewage
- Waste water
- Farm residue

Materials

Motorcasing	SUS 316
Shaft seal	SIC / CC
Impeller	Cast Iron
Shaft Material	SUS 316
Pump casing	Cast Iron

Additional information

Max submerged depth	20m
Max. Liquid temp	40 °C
pH Liquid	6 - 8
Float options	• Floatswitch

Unique Properties

The GS series of pumps are heavy duty sewage pumps with a grinder below the impeller. Constructed with dual mechanical seals in a large oil chamber. Durable SIC / SIC seals employed at impeller side and C/C seal at motor side.

The high pressure performance of the GS grinder pump, makes this series particularly suitable for pumping sewage over long distances or into pressurised sewage systems.



Type: GS1200

1¼" Grinder pump - 230V



Performance

Liquid	Waste water
Capacity	120 l/min (7,2 m3/h)
Delivery head	20m

Technical details

Delivery connection	1¼" female thread
Nett Weight	31 kg
Gross Weight	32 kg
Dimensions	510 x 170 x 310mm

Motor

Absorbed Power (P1)	1.2kW
Rated Power (P2)	0.75kW
Nominal current	6.8A
Protection class	IP68
Power cable	10m H07-RNF
Voltage / phase / Hz:	230V / 1-Phase / 50Hz
Motor protection	Thermal

230V / 50Hz

Grinder pump

Usage:

- Sewage
- Waste water
- Farm residue

Materials

Motorcasing	SUS 316
Shaft seal	SIC / CC
Impeller	Cast Iron
Shaft Material	SUS 316
Pump casing	Cast Iron

Additional information

Max submerged depth	20m
Max. Liquid temp	40 °C
pH Liquid	6 - 8
Float options	• Floatswitch

Unique Properties

The GS series of pumps are heavy duty sewage pumps with a grinder below the impeller. Constructed with dual mechanical seals in a large oil chamber. Durable SIC / SIC seals employed at impeller side and C/C seal at motor side.

The high pressure performance of the GS grinder pump, makes this series particularly suitable for pumping sewage over long distances or into pressurised sewage systems.





JS PUMP

GST12(GS1200)/GST15(GS1500)/GST22/GST37 (1.2 ~ 3.7KW)



□ Application

- AVAILABLE FREE STANDING OR GUIDE RAIL MOUNTED FOR FIXED INSTALLATION.
- DOMESTIC AND INDUSTRIAL APPLICATIONS WHERE EITHER HIGH HEADS OR LONG DISTANCES PROHIBIT THE USE OF STANDARD SUBMERSIBLE PUMPS OR LARGE BORE DISCHARGE PIPE IS NOT AVAILABLE OR ECONOMIC TO INSTALL.
- FOR PROCESS WORKS TO COPE WITH WASTE WATER WITH ORGANIC SOLIDS.
- FOR EFFICIENT DISPOSAL OF SEWAGE AND FARM WASTE TO EITHER MAINS SEWERS OR TO ON SITE TREATMENT WORKS FOR PROCESSING.
- PACKAGE SEWAGE STATIONS AND PORTABLE SEWAGE PUMPING.
- MOST NUISANCE WATER DRAINAGE IF ORGANIC SOLIDS ARE PRESENT.
- GST12(GS1200), GST15(GS1500) WITHOUT SENSOR

□ Construction

GST12/GST15 GS1200/GS1500

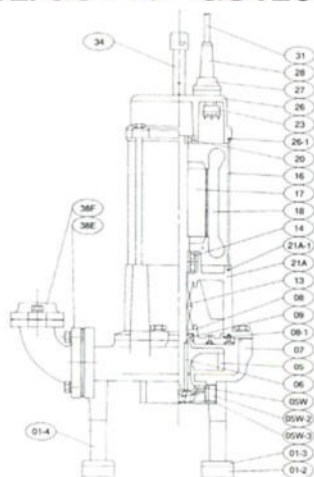

GST22/GST37

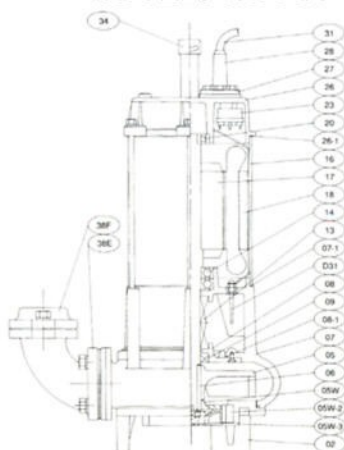

□ Installation on guide rail

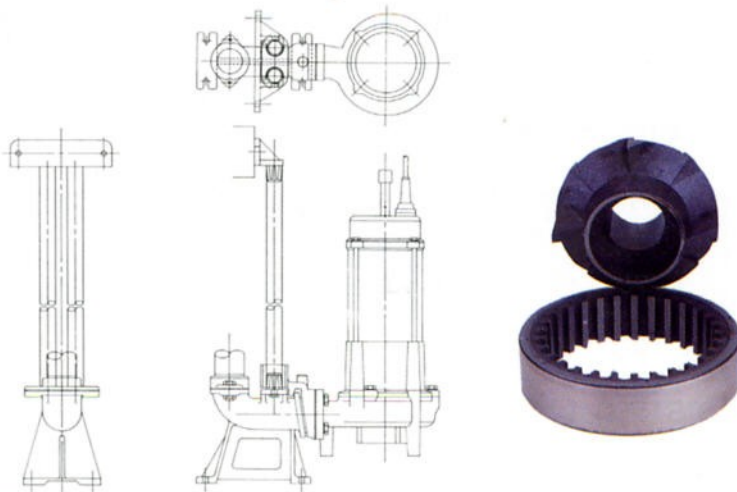

NO.	DESCRIPTION	MATERIAL	NO.	DESCRIPTION	MATERIAL
01-2	CUSHION	NBR	17	ROTOR	SUS 304
01-3	COVER	SUS 304	18	STATOR	H23
01-4	CANNULA	SUS 304	20	BEARING (UPPER)	
05	IMPELLER	FC 200	21A	MOTOR BOTTOM COVER	FC 200
05W	SHREDDING	HICRFC	21A-1	GASKET	NBR
05W-2	GRINDING	HICRFC	23	OVERLOAD PROTECTOR	
05W-3	COVER	FC 200	26	UPPER COVER	FC 200
06	KEY	SUS 304	26-1	GASKET	NBR
07	PUMP HOUSING	FC 200	27	CABLE GLAND	PC/SUS
08	OIL CHAMBER	FC 200	28	RUBBER SLEEVE	NBR
08-1	GASKET	NBR	31	CABLE	PVC
09	LIP SEAL	NBR	34	HANDLE	SUS 304
13	MECHANICAL	SIC/CAR	38E	OUTLET	FC 200
14	BEARING (LOWER)		38F	OUTLET	FC 200
16	MOTOR CASE	SUS 304	D31	SENSOR	CU

Performance Curves

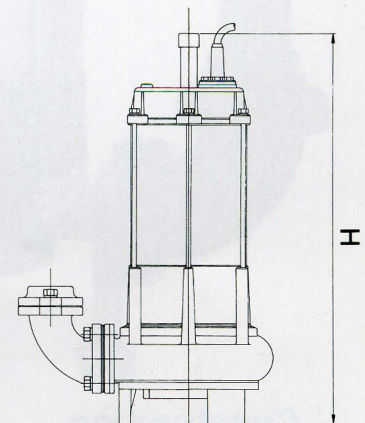
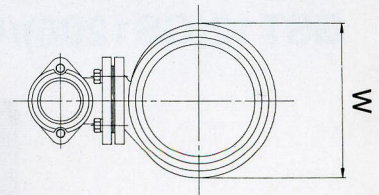
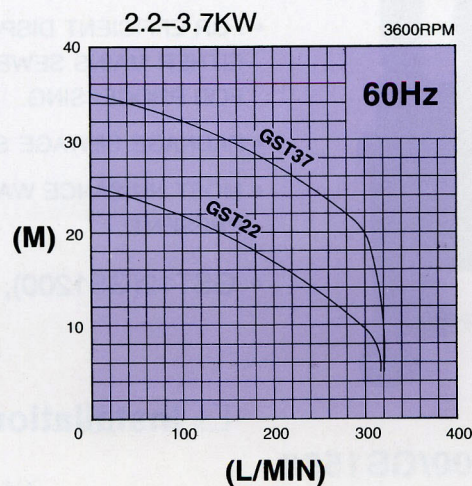
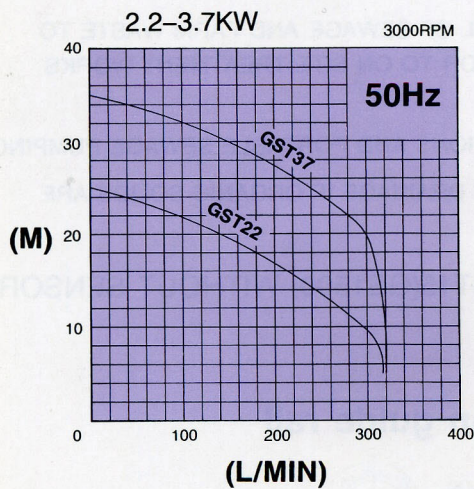
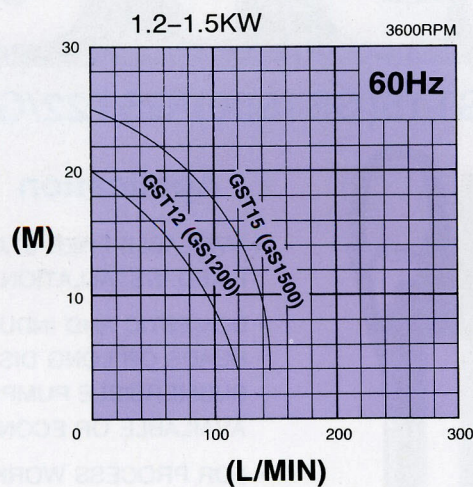
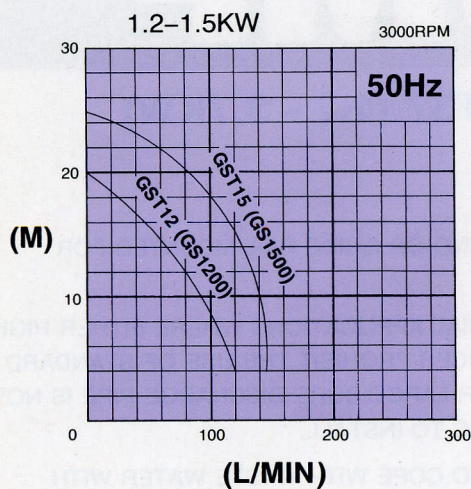

Specifications

Pump type	Output H.P.	Discharge [inch]/[mm]	Voltage 50Hz or 60Hz	Continuous		Weight kg	Dimension[mm]	
				Head m	Capacity L/min		H	W
GS1200	1.6	1 1/4" [32]	1 phase 110-220V	15	60	31	460	180
GS1500	2			21	60	34	470	180
GST12	1.6		3 phase 220-460V	15	60	31	450	180
GST15	2			21	60	34	460	180
GST22	3	2" [50]	3 phase 220-460V	20	120	49	520	240
GST37	5	[50]		30	120	52	530	240